

AHRENS

**chimney
technique**

Styro-Form™ Crown Form

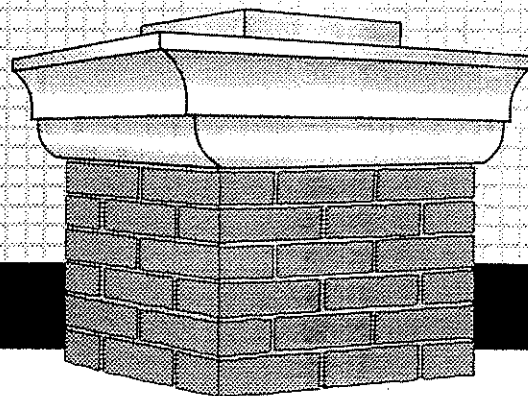

INSTALLATION INSTRUCTIONS

TOP VIEW

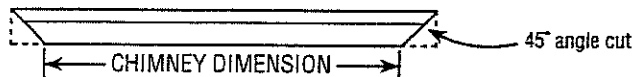

Please read all instructions before you begin.

STEP 1
Measure and
cut sides

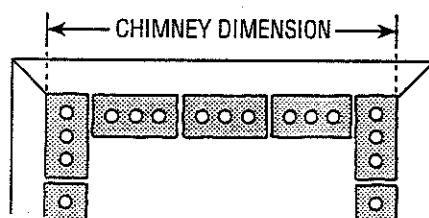

1. Measure the outside dimensions of chimney and apply dimensions to the **Ahrens Crown Styro-Form** in the manner shown at left.

A cardboard 45° template is provided in each box for your convenience. Simply bend into a rectangle and tape together, slide guide over form and use a typical wood hand saw to cut 45° angle.

NOTE: Form splices should be located in the **center** of a reinforcing triangle. (See #4 continued on back for details.)

STEP 2
Secure corners with tape

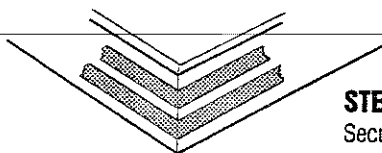

2. Once all four sides have been cut, assemble form by taping corners together using duct tape. (We recommend two pieces of tape 12" long on each corner.)
3. To place form on chimney, release tape on one corner and wrap form around the chimney and refasten tape. Adjust form to proper elevation as shown at left.

STEP 3
Wrap around chimney and
adjust to proper elevation

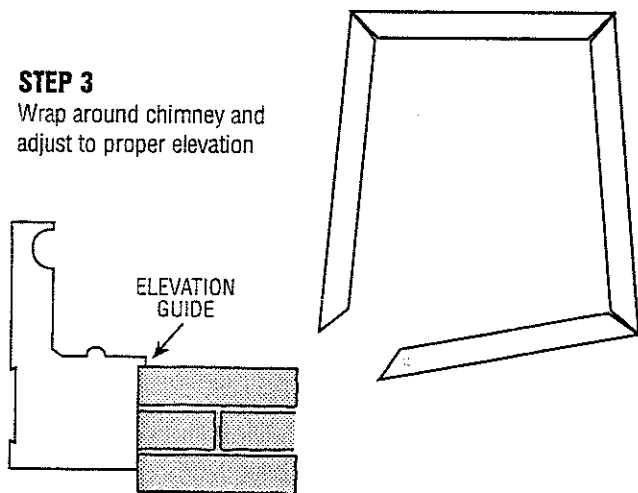

STEP 4
Push reinforcing triangles
into place on all sides

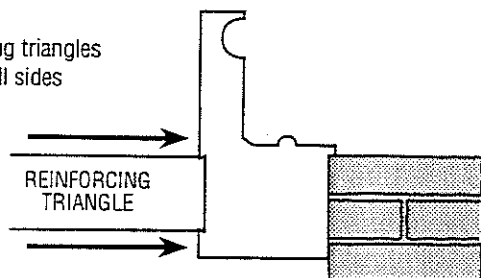

4. Reinforce form by pushing long side of reinforcing triangles into notch on outside of form as shown.

Forms longer than 48" should utilize 12" reinforcing triangles to create more side force over a longer distance.

CONTINUED ON BACK

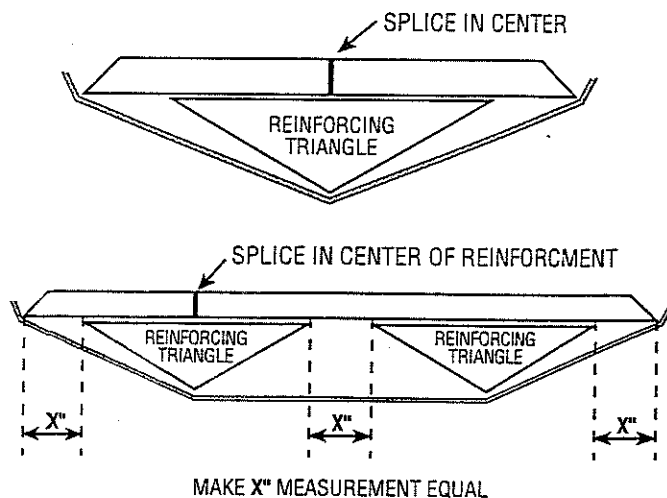

MAKE X" MEASUREMENT EQUAL

STEP 5

Wrap and tighten strap around all sides and reinforcements

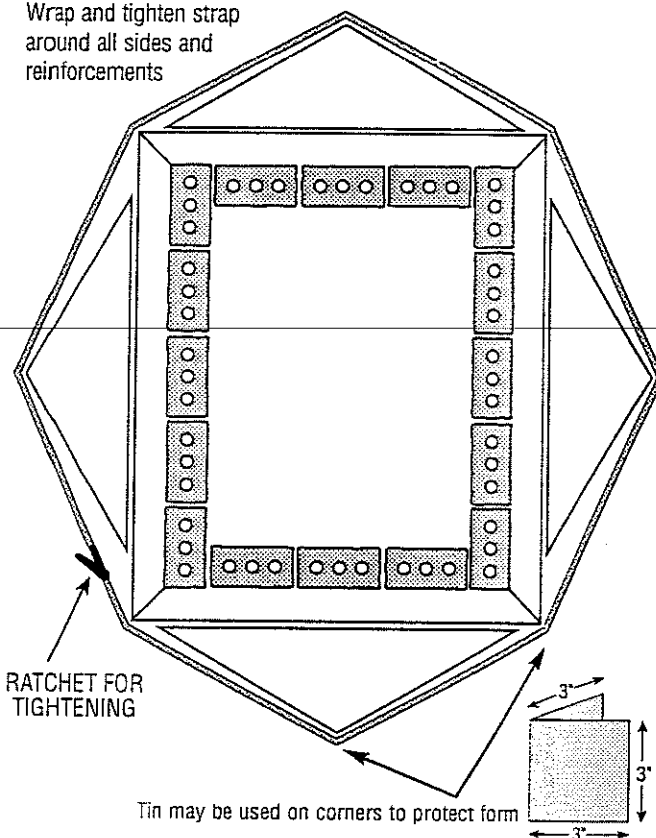

Tin may be used on corners to protect form

* SUPPORT WIRES

- For added support on crowns longer than 3'
- One support wire recommended every 16"

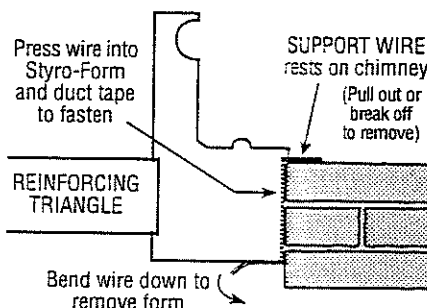

4. (CONTINUED)

For crowns 64" to 96" position reinforcing triangles with equal distance from sides and between triangles as shown. (*X" dimension*)

NOTE: These triangles are reusable. We recommend applying tape to corners to prolong life of triangles. Also, a piece of tin can be installed between strap and forming material to keep strap from "cutting in" when tightening.

5. Once reinforcing triangles have been installed on all four sides, wrap 1" nylon strap around form and triangles and tighten.

(Two straps hooked together may be needed on larger crown forms)

***NOTE:** ; on longer sides is normally reduced and may want to sag somewhat due to weight of the concrete. Use of support wire is recommended.

6. Spray inside of forms with **Release™** form release agent.

CAUTION: Products other than **Release™** may melt the Styro-Form Product.

7. Mix concrete at the following ratios:

- 1 part— Portland Cement
- 2 parts— Concrete Sand
- 3 parts— 3/8 to 1/2" Rock

Mixture should be placed slightly wetter than normal to assure consolidated edges.

Once placed, a margin trowel can be used to agitate edges. Move trowel up and down in the concrete as you work around form.

8. Once concrete has set for a minimum of 24 hours, strip forms. Simply release strap, remove reinforcing triangles and tape from all four corners. Carefully pull form downward and away from sides of concrete.

If you find edges not consolidated properly or small holes exist, a surface treatment can be mixed as follows:

- 1 part— Portland Cement
 - 3 parts— Masonry Sand
 - Water— to achieve slightly wetter than mortar-like consistency
- (MorBond™ should be added for better adhesion)

Apply to surface with sponge float or paint brush.



A Product of:
AHRENS CHIMNEY TECHNIQUE INC.
 2000 Industrial Avenue • Sioux Falls, SD 57104
 CALL 1-800-843-4417

For more information on proper Crown Construction, see Section 10 in Chim-Pro™ Catalog & Handbook.

For crowns over 8' x 8', call 1-800-843-4417 for assistance in form design.