

A. W. PERKINS CO.



*Hearth
Country*TM



Model: # 400 **Ash Vacuum**



Dear Customer,

Thank you for buying our Hearth Country™ Ash Vacuum. Our company makes the industry leading vacuum for chimney sweeps, the Rovac® 3 Motor Chimney Cleaning vacuum. Chimney sweeps and hearth retailers have asked us for many years to develop a consumer grade ash vacuum with HEPA filtration. They had seen first hand the damage that can result from using a standard shop vacuum or household vacuum when attempting to clean out a fireplace, wood stove or pellet stove.

The Hearth Country™ Ash Vacuum has the features necessary to clean these appliances without dust passing into the home. Please carefully read and follow these instructions to get the best, dust-free performance from this vacuum. Our web site at www.hearthcountry.com provides additional information about our products.

Very Truly Yours,

Tom Martin
President

A.W. Perkins Company
P.O. Box 637
Rutland, VT 05702-0637
Phone - 800-698-7412
EMail - sales@awperkins.com

----- **LIMITED WARRANTY** -----

A.W. Perkins Company ("AWP") will repair or replace, at its option, any Hearth Country Ash Vacuum deemed by it to be defective within one year of original purchase date. Warranty limited to non-commercial users and shall be in force only for the original purchaser. This warranty does not cover customary filter replacement or cases of owner abuse, malicious destruction, or "acts of God" (including power surges). Proof of purchase will be required, so save your receipt. A Return Goods Authorization Number needs to be requested on all returns by calling or emailing us. Product needs to be returned to our facility, prepaid, at 36 Curtis Avenue, Rutland, VT USA 05701. AWP shall not be liable for any consequential or incidental damages resulting in loss from the use of this product. In no case will AWP's liability exceed the consumer's purchase cost.



Parts List

- 1 SWITCH
- 2 MOTOR TOP COVER
- 3 POWER CORD
- 4 ASH CAN LID
- 5 COVER LATCH (2)
- 6 ASH CAN W/DOUBLE BOTTOM
- 7 METAL HOSE
- 8 LOCKING HOSE CONNECTOR
- 9 HANDLE
- 10 EXHAUST PORT
- 11 SHAKE OFF™ VIBRATION ACTUATOR
- 12 HOSE CUFF
- 13 ALUMINUM PICKUP NOZZLE



ASSEMBLING VACUUM CLEANER - NO TOOLS REQUIRED
ALWAYS REMOVE THE PLUG FROM THE POWER SOCKET BEFORE FITTING OR REMOVING ACCESSORIES!

- A) & B) REMOVE LID. TAKE ALL ACCESSORIES OUT OF THE ASH CAN.
- C) PUT THE NOZZLE ON THE PICKUP END OF HOSE.
- D) INSERT HOSE INTO THE AIR INTAKE ON THE TOP OF VACUUM. PRESS IN AND THEN TWIST UNTIL IT CLICKS INTO POSITION.

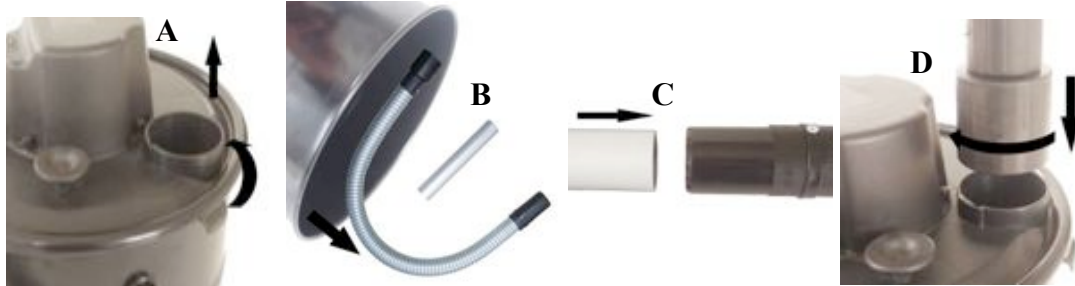

INSTRUCTIONS FOR USE

TWO IMPORTANT NOTES - 1. EACH USE VERIFY THAT HEPA FILTER IS IN PLACE AND THAT HEPA SEAL PLATE WING NUT IS TIGHT. ALWAYS TEST SEAL BY VACUUMING UP A SMALL AMOUNT OF ASH WHILE LOCATED AWAY FROM LIVING AREAS (SEE PG. 5, STEP 10).

2. DO NOT ATTEMPT TO USE VAC TO REMOVE LARGE PILES OF ASH FROM A FIREPLACE OR WOOD STOVE. INSTEAD REMOVE BULK OF ASH WITH A SHOVEL AND ASH CAN (OR HOD) AND THEN USE THE ASH VAC FOR FINAL CLEANUP.

1. PLUG CORD INTO OUTLET, PHOTO 1.
2. PRESS THE ON/OFF BUTTON TO SWITCH THE APPLIANCE ON (2).
3. FOR FIREPLACES AND WOOD BURNING STOVES SEE “IMPORTANT NOTE 2”, ABOVE. PLACE NOZZLE IN FIREBOX. KEEP NOZZLE PRESSED AGAINST THE FLAT SURFACES OF STOVE OR FIREPLACE TO LIMIT ENTRANCE OF LARGE CHUNKS INTO PICKUP TUBE. USE THE SHAKE OFF FEATURE AFTER APPROXIMATELY EACH 1 CUP OF ASH IS REMOVED OR WHEN SUCTION IS REDUCED. SHAKER INSTRUCTIONS ARE BELOW. IF LARGE CHUNKS ARE PICKED UP TURN OFF MACHINE TO DISLodge (3).



HOW TO USE THE SHAKE OFF™ VIBRATION FEATURE

When the suction is reduced or after about 1 cup of ash has been removed use the SHAKE OFF knob to help remove ash from filter without taking off the lid.

- A. TURN OFF MACHINE! (1 below)
- B. Hold can down and retract SHAKE OFF knob fully (2 below).
- C. Release so knob bangs top lid (3).
- D. This will send vibrations through the top lid to the filter to help clear debris (interior view 4). Repeat 5 to 10 times. Suction should now improve at startup.

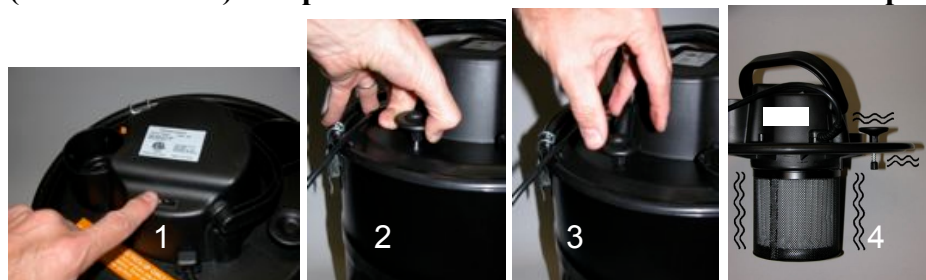

4. WHEN FINISHED CLEANING TURN SWITCH OFF, PHOTO 4.
5. REMOVE THE PLUG FROM THE OUTLET AND TAKE VACUUM TO AN OUTSIDE LOCATION AWAY FROM VALUABLES AND BREEZES (5).
6. RELEASE THE FLEXIBLE HOSE FROM THE AIR INTAKE DUCT. A SMALL AMOUNT OF ASH MAY BE GENERATED SO TAKE CARE (6).
7. VERIFY ASH IS COLD! ALLOW TO COOL FURTHER IF NEEDED, THEN DUMP DEBRIS. ASH IS A GREAT GARDEN SUPPLEMENT! (7)



8. ****EVERY 3 TO 5 USES CLEAN HEPA FILTER WHILE OUTSIDE AND AWAY FROM VALUABLES. SCREW OFF THE FILTER WING NUT AND REMOVE MESH COVER AND HEPA SEAL PLATE (NOT SHOWN). TAKE THE FILTER OUT FOR CLEANING (SEE 9, BELOW) OR CHANGE.**

Follow steps below from 1 to 3 for taking off the filter.

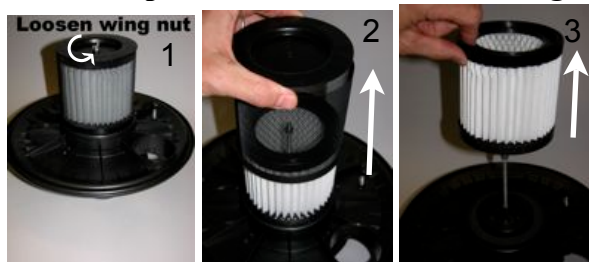

Note: This process will be dusty. Pictures depict clean machine for illustrative purposes.

9. **CLEANING FILTER - TO LIMIT DUST PLACE HEPA FILTER INSIDE A PLASTIC BAG (not incl.). TO CLEAN FILTER TAP GENTLY AGAINST A HARD SURFACE. EMPTY PLASTIC BAG AND INSPECT FILTER. DUST WITHIN THE FILTER PLEATS MAY REQUIRE GENTLE FLEXING OF THE FILTER BY SQUEEZING THE FILTER'S RUBBER SEALS SO AS TO MAKE THE FILTER OVAL INSTEAD OF ROUND. TAP FILTER WHILE "OUT OF ROUND" TO GET DEEPLY SET DUST OUT OF PLEATS.**

Follow steps below from 4 to 7 for re-assembly of the filter

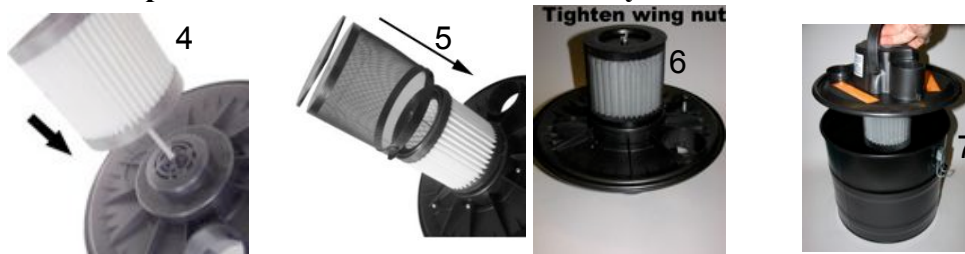

10. **IMPORTANT - WITH FILTER INSTALLED AND LID IN PLACE TURN VACUUM ON AT A DRY OUTSIDE LOCATION TO TEST FILTER SEAL. LOOK FOR DUST AT THE EXHAUST PORT. A SMALL AMOUNT IS NORMAL AFTER CLEANING FILTER. VACUUM UP A SMALL AMOUNT OF ASH WHILE STILL OUTSIDE TO GIVE FINAL ASSURANCE OF A GOOD SEAL AND TO VERIFY FILTER INTEGRITY. REPLACE FILTER IF DUST PASSES THROUGH AT THIS POINT.**

SPECIAL NOTES - IMPORTANT!

- **FILTER SHOULD BE REMOVED AND THOROUGHLY CLEANED MONTHLY OR AFTER EACH 3 TO 5 USES. CLEAN OUTSIDE AWAY FROM VALUABLES! SEE STEP 9 ABOVE.**
- **ALWAYS OPERATE THE CLEANER WITH THE FILTER INSTALLED. OTHERWISE, DUST PASS-THROUGH OR MOTOR DAMAGE MAY RESULT.**
- **DISCONNECT POWER CORD FROM ELECTRICAL OUTLET, BEFORE CLEANING FILTER, SERVICING OR REMOVING LID.**
- **DO NOT USE A WASHING MACHINE TO WASH FILTER.**
- **DO NOT USE HAIR DRYER OR MICROWAVE TO DRY FILTER.**
- **FILTER SHOULD BE FLEXED CAREFULLY TO REMOVE ASH BUILDUP. MOIST ASH WILL BE TOUGH TO REMOVE, ALLOW TO DRY IF NECESSARY, THEN CLEAN WHEN DRY.**
- **DO NOT POKE AT FILTER OR RUB FILTER AS THIS MAY TEAR THE FABRIC AND LEAD TO DUST PASS-THROUGH.**
- **REPLACE FILTER ONCE A YEAR, OR AFTER ABOUT 50 USES OR IF DUST PASSES THROUGH AFTER FILTER CLEANING, SEE 10 ABOVE.**

IMPORTANT SAFETY INSTRUCTIONS

When using an electrical appliance, basic precaution should always be followed, including the following:

READ ALL INSTRUCTIONS BEFORE USING THIS VACUUM

WARNING - To reduce the risk of fire, electric shock, or injury:

1. Do not leave vacuum cleaner when plugged in. Unplug from outlet when not in use and before servicing.
2. To reduce the risk of electric shock, do not use outdoors or on wet surfaces
3. Do not allow to be used as a toy. Close attention is necessary when used with children nearby.
4. Use only as described in this manual. Use only manufacture's recommended attachments.
5. Do not use with damaged cord or plug. If vacuum cleaner is not working as it should, has been dropped, damaged, left outdoors, or dropped into water, enter it to a service center or contact manufacturer.
6. Do not pull or carry by cord, use cord as a handle, close lid on cord, or pull cord around sharp edges or corners. Do not run vacuum cleaner over cord. Keep cord away from heated surfaces.
7. Do not unplug by pulling on cord. To unplug grasp the plug, not the cord.
8. Do not handle plug or vacuum cleaner with wet hands.
9. Do not put any object into openings. Do not use with any opening blocked. Keep exhaust free of dust, lint, hair and anything that may reduce airflow.
10. Keep hair, loose clothing, fingers and all parts of body away from openings and moving parts.
11. Turn off all controls before unplugging.
12. Use extra care if used when cleaning stairs.

13. Do not use to pick up flammable or combustible liquids, such as gasoline, or use in areas where they may be present.
14. Hold plug when rewinding onto cord reel. Do not allow plug to whip when rewinding.
15. Unplug before connecting the hose.
16. Do not pick up anything that is burning or smoking, such as cigarettes or matches.
17. Do not use without filter in place.
18. If the supply cord is damaged, it must be replaced by the manufacturer or its service agent or a similarly qualified person in order to avoid a hazard.

SAVE THESE INSTRUCTIONS

WARNING - to reduce the risk of electric shock, this vacuum cleaner has a polarized plug (one blade is wider than the other). This plug will fit in a polarized outlet only one way. If the plug does not fit fully in the outlet, reverse the plug. If it still does not fit, contract a qualified electrician to install the proper outlet. Do not change the plug in any way.

PRECAUTIONARY MEASURES

If the opening that sucks in the air or the suction pipe are blocked, you should switch off the vacuum cleaner at once. First clear the blocked substance before you attempt to start the vacuum cleaner again.

1. Do not operate the vacuum cleaner too close to heaters and items like radiators, cigarettes, etc.
2. Before you insert the plug into the wall contact, make sure your hand is dry.
3. When you want to pull the plug from the wall contact, please do this at the plug itself and not by means of the electrical cable.

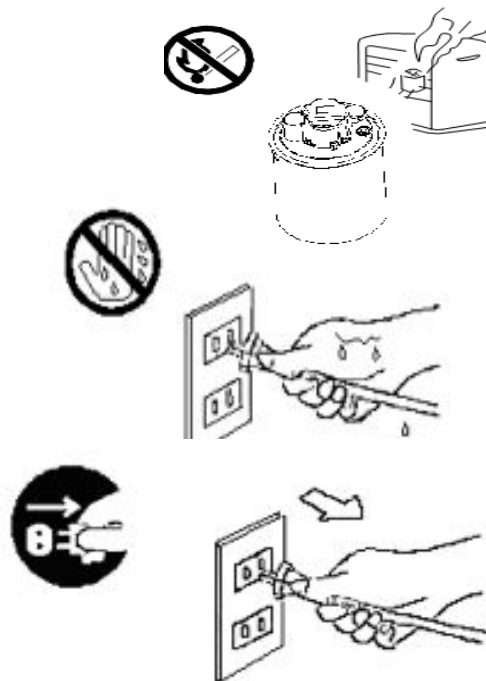

Model #:	400
Voltage (V)	120
Frequency (Hz)	60
Power: (W)	800
Max Vacuum:(Kpa)	17
Sound Level Max:(dB)	<84
Max Airflow (CFM)	85

Special NOTE: This vacuum's motors are equipped with thermal "overheat" protection. If the motors run too hot then they will shut down. You must wait for motor to cool and unplug unit in order to re-start vacuum. Cleaning the filter will help prevent a repeat of this condition.

Spare Parts Ordering - Refer to photo on page 3.

Visit our web site - www.hearthcountry.com

Email - sales@awperkins.com

Or call us at 800-698-7412, 8 to 5 U.S. Eastern Time

Mail - P.O. Box 637, Rutland, VT 05702-0637 U.S.A.

Accessories



#412 Pellet Stove Accessory Kit - 18" of small diameter hose, adapter to fit inside standard hose cuff, 2 mini-extensions, mini-crevice tool and brush. Cold use only.

#411 HEPA Filter -
Replace every 50 uses
or as needed.



#85315 - 1½" "Stayput" Hose extends, flexes and then holds its shape. Extends from 14" to 36" long. Great for reaching into dirty wood stoves or reaching up to clean the smoke shelf or behind dampers to get at hard to reach debris. Slides over the aluminum pickup nozzle (part 13 on page 3). Cold use only.



Try our other great A.W. Perkins Company products for fireplaces, wood burning stoves and pellet stoves. Available from fine hearth shops, hardware stores and over the internet.



Creosote Remover for stoves & inserts
Changes creosote to a brushable ash.
#190 - Qt.
#191 - Gallon



Gel Flame Fire Starter for pellet stoves, wood stoves, fireplaces.
#10 - Pt. #11 - Qt.



Break-n-Burn Fire Starter squares. Safe to use and store. They light by match touch.
#22 - 24 sq. per box
#25 - 144 sq. per box



HearthGlass Creme for glass-ceramic wood stoves, pellet stoves and inserts. Unsurpassed for cleaning baked on soot. #101 - 8 oz.

Daryle's Poe™
Its not a poker, its not a hoe.... its the unbeatable Poe. 36" handle, Vt. made stove rake. #POE