

LITEROCK INSTALLATION METHOD

* Read below information when using LiteRock Installation Method. Conventional model shown throughout.

The FireRock LiteRock system is an installation method that allows our wood burning fireplace to be installed directly onto a combustible surface, typically without additional structural support.

NOTICE

Before installing onto the combustible floor system, it is important that the building contractor has verified independently that the floor system is able to withstand the weight of the installation, including the chimney. Failure to ensure the floor system can withstand the weight of the installation can cause significant property damage, including, but not limited to, the fireplace unit falling through the subfloor. It is the responsibility of the general contractor to ensure adequate foundations.

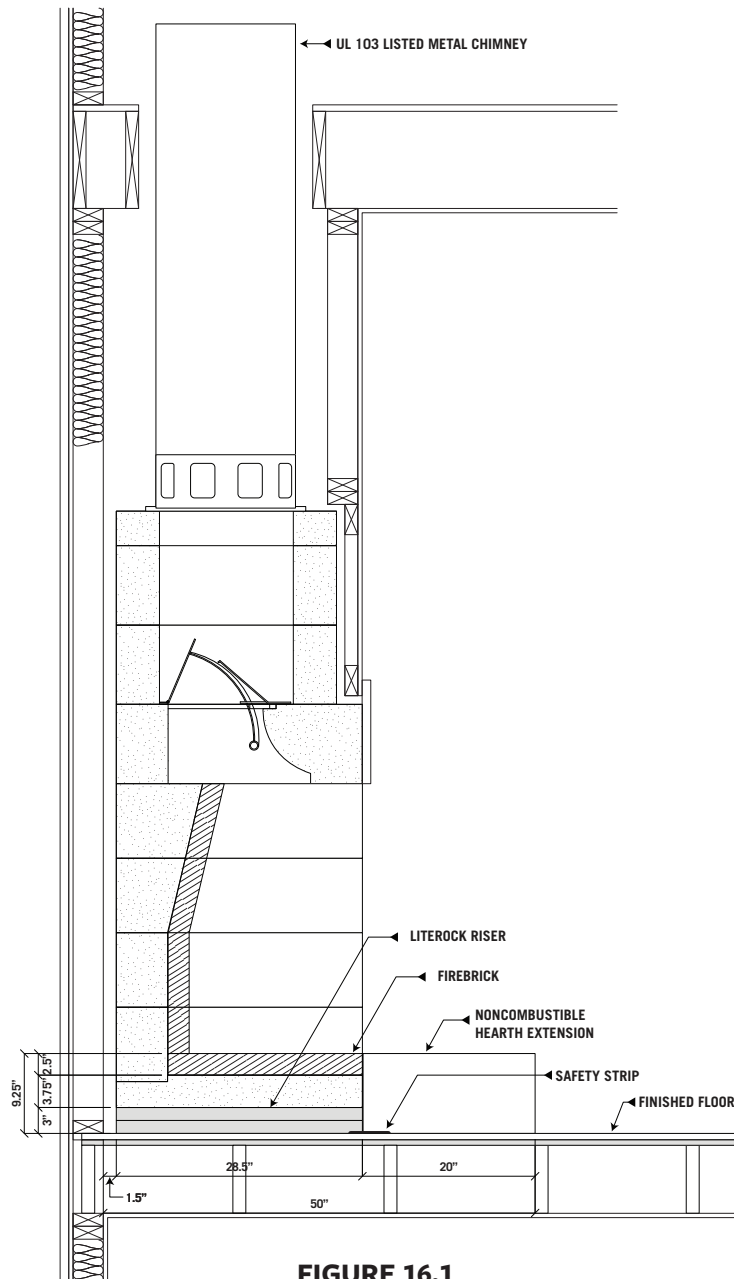

FIGURE 16.1

The components of the LiteRock system include a FireRock fireplace, UL 103 approved lightweight metal chimney and a 3" riser kit purchased from your FireRock dealer.

▲ WARNING

This specialty material has been tested to minimize heat output through the base plate and **cannot** be substituted with other material. Substituting the riser kit with another material may result in a fire or explosion, causing property damage, personal injury, or loss of life.

The LiteRock installation method is approved for FireRock Conventional/California Conventional (30", 36", 42", 48"), FireRock Rumford (30", 36", 42", 48") and FireRock See Through (30", 36", 42", 48"). All sizes follow the same installation instructions.

The riser is made up of two (2) 1 1/2" boards that stack on top of one another to form a 3" riser. The boards should be pre-cut to the size of your base plate.

IMPORTANT: If the boards do not match the size of your base plate, call your FireRock dealer before installation.

IMPORTANT: The LiteRock Installation Method is designed, tested and approved for installation at a minimum of three (3) inches above combustible floor systems per the installation specifications given in this manual.

▲ WARNING

Follow all previously stated clearance to combustibles when installing a FireRock fireplace using the LiteRock installation method.

LITEROCK INSTALLATION METHOD

(CONTINUED)

3" LITEROCK RISER – INSTALLATION

The LiteRock installation method of the FireRock fireplace results in the finished firebrick floor of the firebox being at least 9 ¼" above the combustible floor system (Figure 16.1).

STEP 1: It is very important that your base plate be square to the room, properly centered, and level. Mark out the position of the base plate on the supporting floor system.

STEP 2 (FIGURE 16.2): Place a noncombustible safety strip (i.e., 4" galvanized flashing) so that it will protrude past the front of the riser kit a minimum of 3". Tack with nails or adhesive (not included).

STEP 3 (FIGURE 16.3): Position the first board on top of the combustible floor where the base plate will be placed. Remember to place the board so that the safety strip protrudes a minimum of 3" from the front of the riser kit.

STEP 4 (FIGURE 16.4): Place the second board on top of the first board. Do not mortar the boards together.

STEP 5 (FIGURE 16.5): Place the base plate on top of the two boards (3" riser).

Once the riser has been assembled and installed, installation of the firebox and smoke chamber follow the same instructions as shown previously in the manual. Refer to pages 17-19.

▲ WARNING

The FireRock base plate **is mandatory** for the LiteRock Installation Method. Failure to use a base plate with this installation method may result in a fire or explosion, causing property damage, personal injury, or loss of life.

Once the firebox and smoke chamber are complete, transition to a UL 103 approved metal chimney system. Refer to the manufacturer's instructions for installation requirements.

NOTICE

A noncombustible hearth extension must cover the combustible floor at least 20" out in front of the finished firebox opening and 8" beyond the finished sides of the opening.

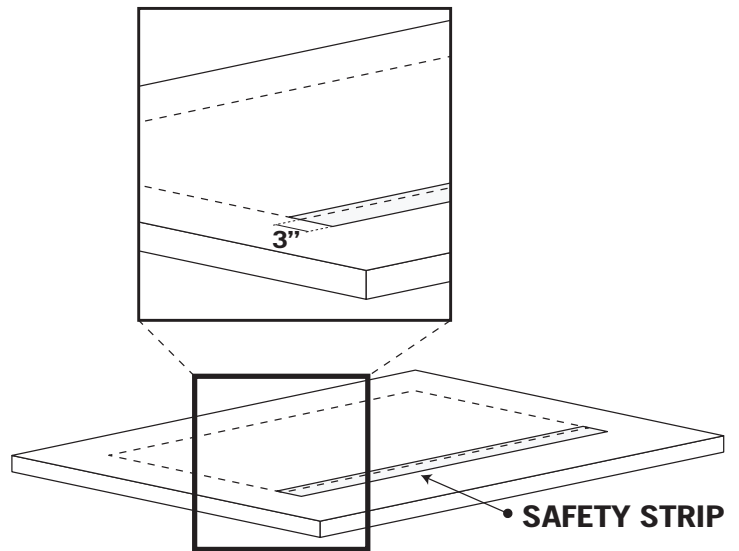

FIGURE 16.2

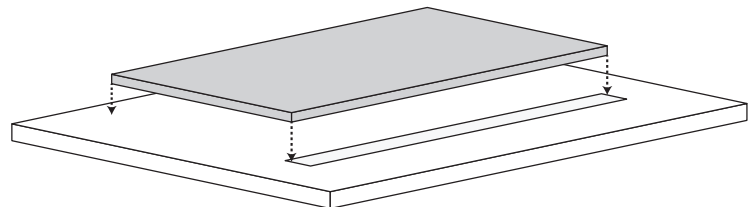

FIGURE 16.3

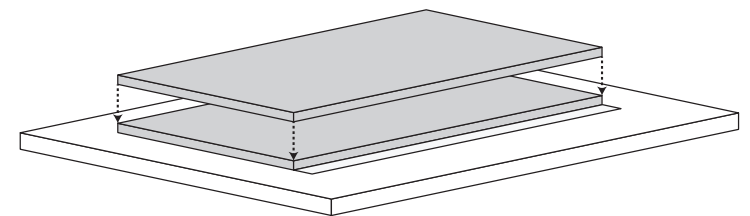

FIGURE 16.4

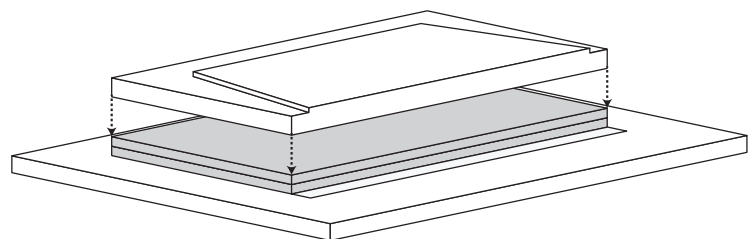

FIGURE 16.5

LITEROCK INSTALLATION METHOD

(CONTINUED)

FLUSH HEARTH WITH LITEROCK RISER

If the design calls for a flush hearth, special consideration must be taken before lowering and setting the LiteRock on the joist system. When calculating flush hearth height, be sure to account for both the 3" LiteRock riser, the 3¾" base plate, and the 2½" thick firebrick floor (a total of 9¼").

Whether using a flush hearth or a raised hearth, a noncombustible hearth extension must cover the combustible floor at least 20" out in front of the finished firebox opening and 8" beyond the finished sides of the opening.

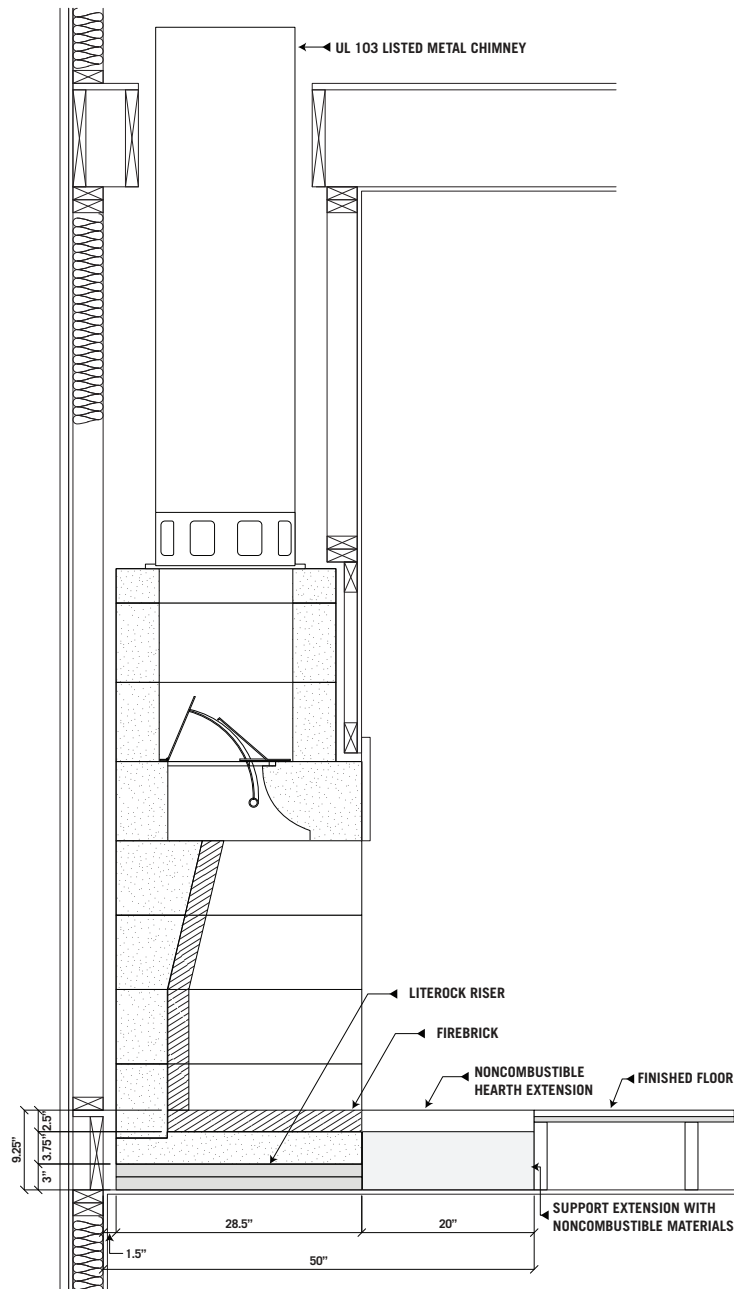

FIGURE 16.6

IMPORTANT: When installing the LiteRock Riser as a flush hearth application, the noncombustible hearth extension **must** be supported by noncombustible materials (Figure 16.7). All materials that abut the fireplace or riser material **must** be noncombustible.

▲ WARNING

The FireRock base plate **is mandatory** for the LiteRock Installation Method. Failure to use a base plate with this installation method may result in a fire or explosion, causing property damage, personal injury, or loss of life.

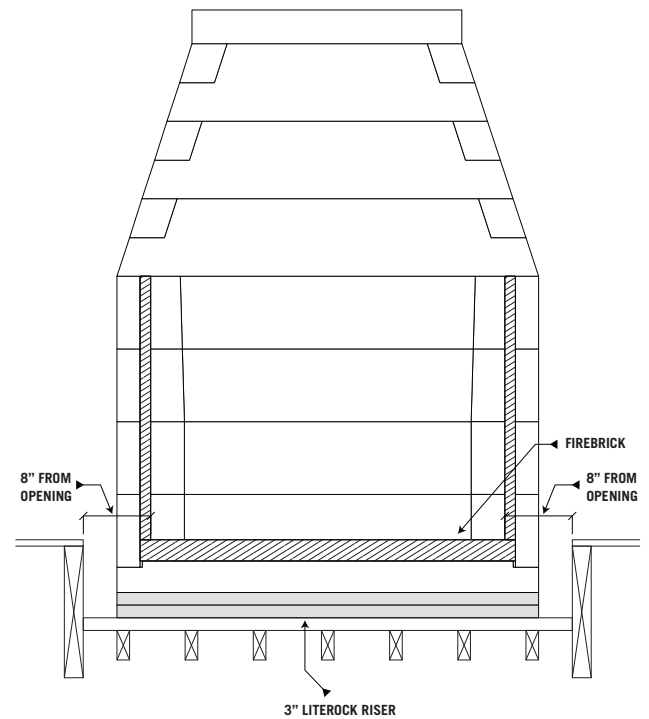

FIGURE 16.7