

# INSTALLATION AND SPECIFICATION PAGE FOR FIRE ROCK FIRE PIT

## Site Preparation:

- Generally, a concrete pad 4 – 6 inches thick with footings as dictated by local building codes, is the best surface on which to erect any fire feature.
- With proper ground preparation, such as the gravel and sand layering under a paver patio, a Fire Rock Fire Pit may be installed without a concrete foundation.
- If it is your intention to install this product on a combustible surface (wooden deck), take extra precautions to insulate the surface under and surrounding the Fire Pit so that neither heat transference nor sparks present a hazard.

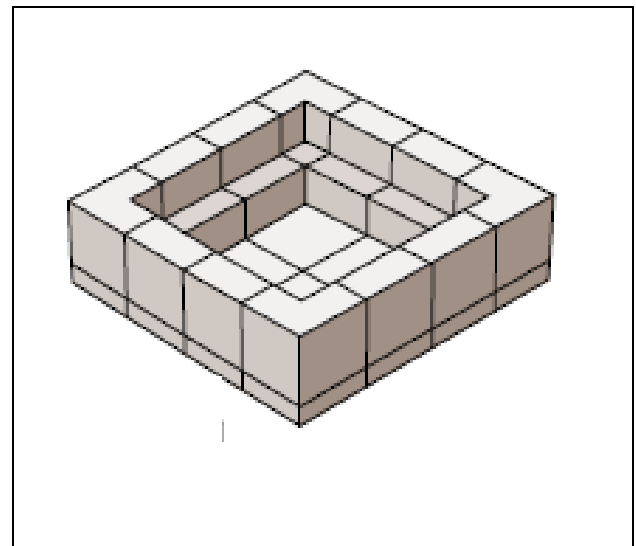
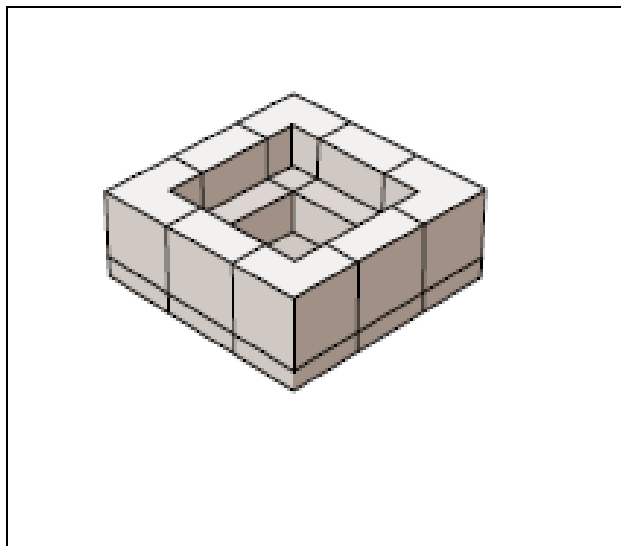
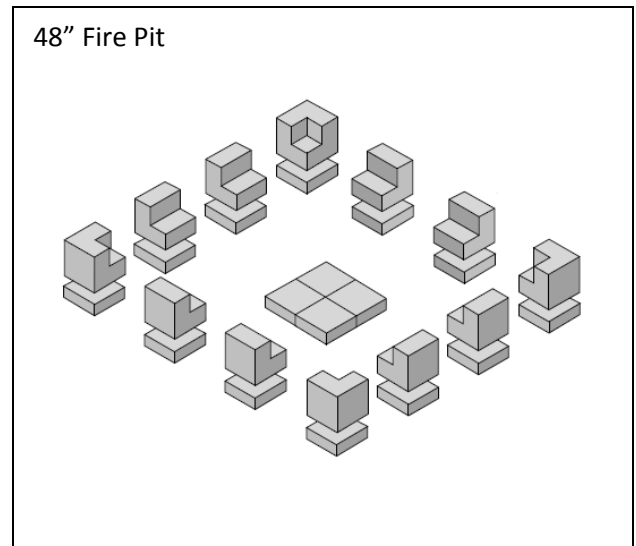
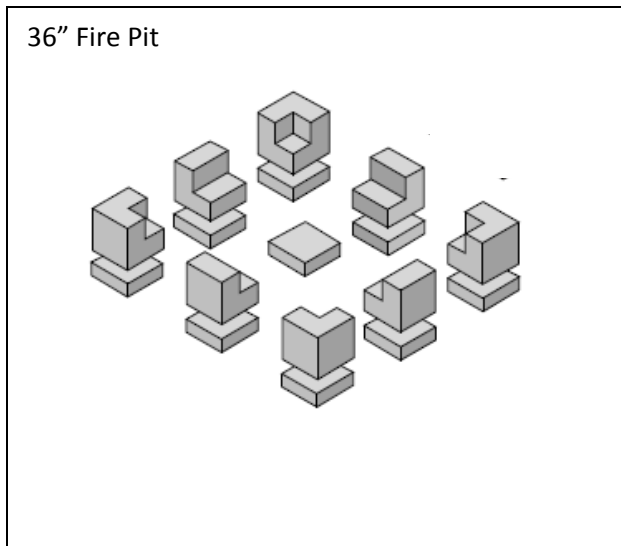

Each surface connecting with another surface must be generously covered with Fire Rock Adhesive Mortar.



**FireRock Building Materials**  
205.639.5000  
Toll Free: 888.876.1025  
Fax: 888.886.3473

MANUFACTURING:  
3620 AVENUE C  
FAIRFIELD, AL 35064

ADMINISTRATIVE:  
1500 1st AVENUE N, #75  
BIRMINGHAM, AL 35203

# FireRock

The fireplace, rekindled.  
**SQUARE FIRE PIT**

#	COMPONENT NAME
1	BASE BLOCK
2	CORNER BLOCK
3	INTERIOR BLOCK
4	CORNER BLOCK (opposite side)

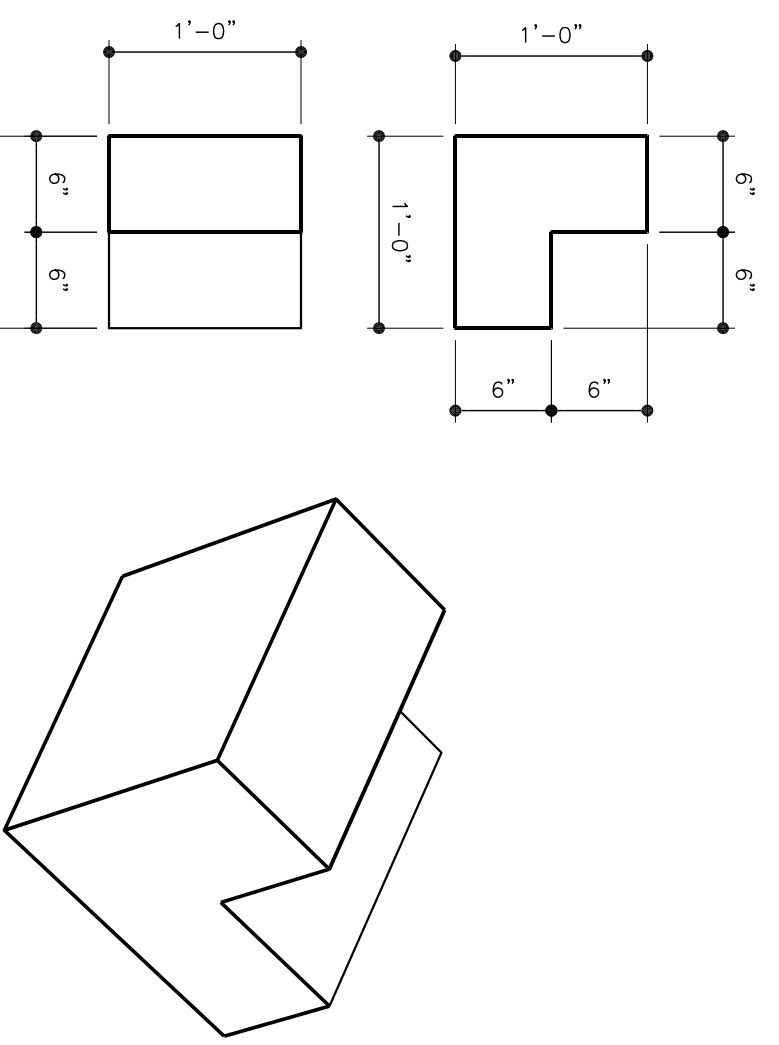

**3**  
**INTERIOR BLOCK**

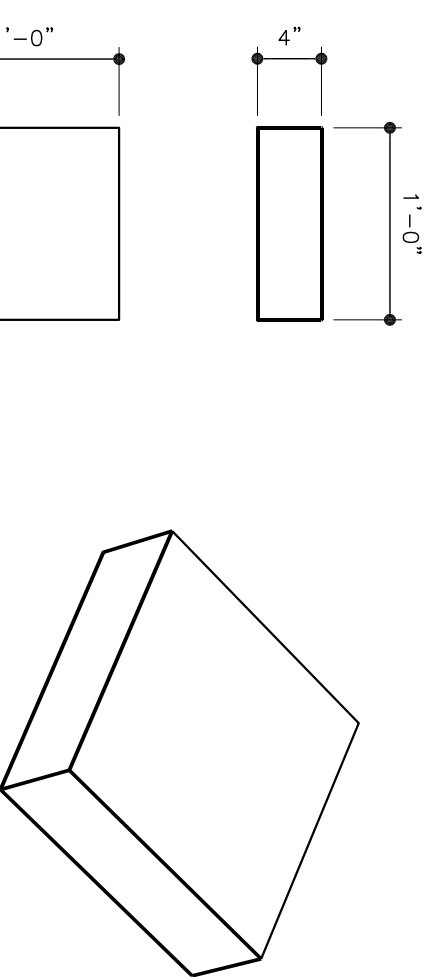
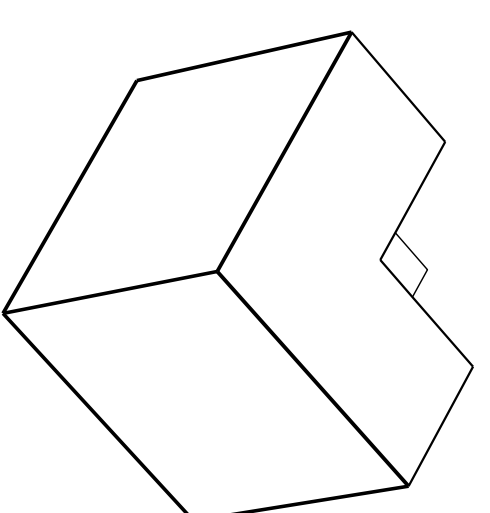

**1**  
**BASE BLOCK**

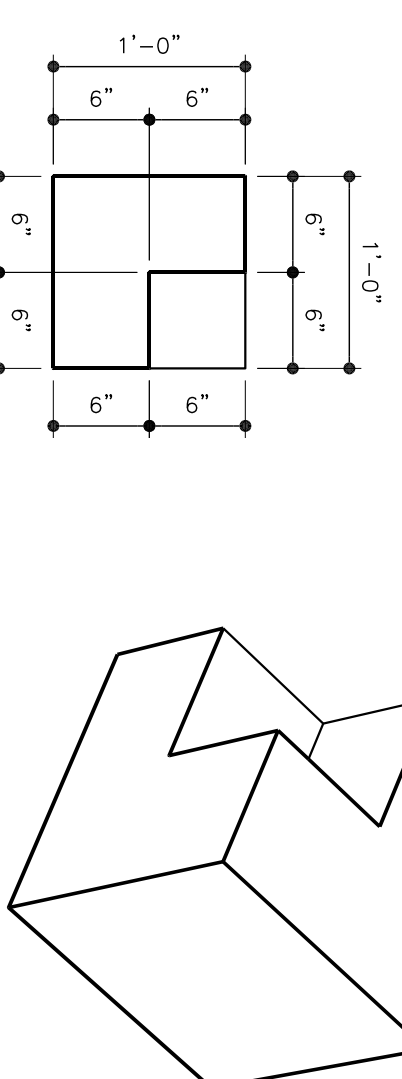

**4**  
**OPPOSITE CORNER BLOCK**  
SEE CORNER BLOCK #2 DIMENSIONS

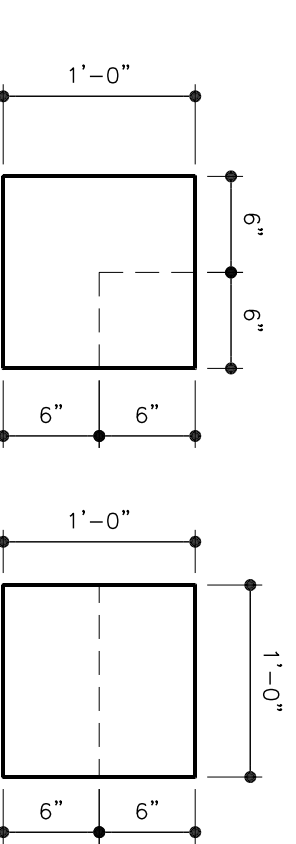

**2**  
**CORNER BLOCK**

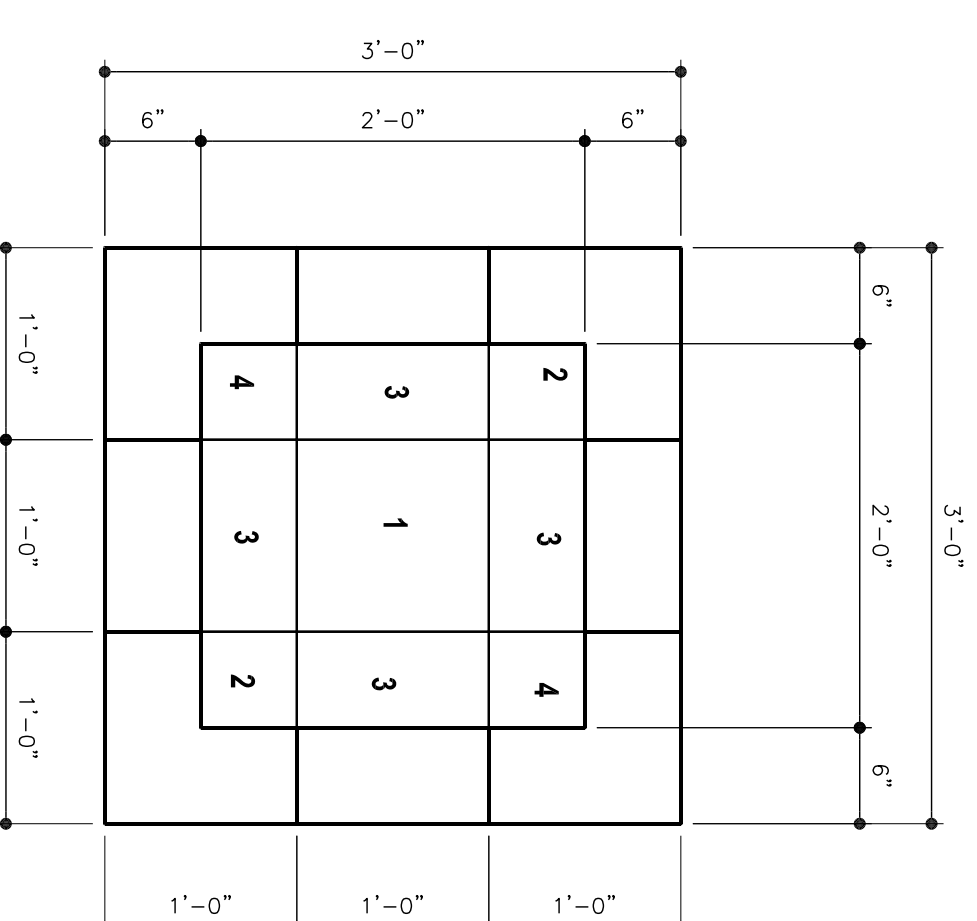

**FIRE PIT PLAN**

SCALE: 1" = 1'-0"

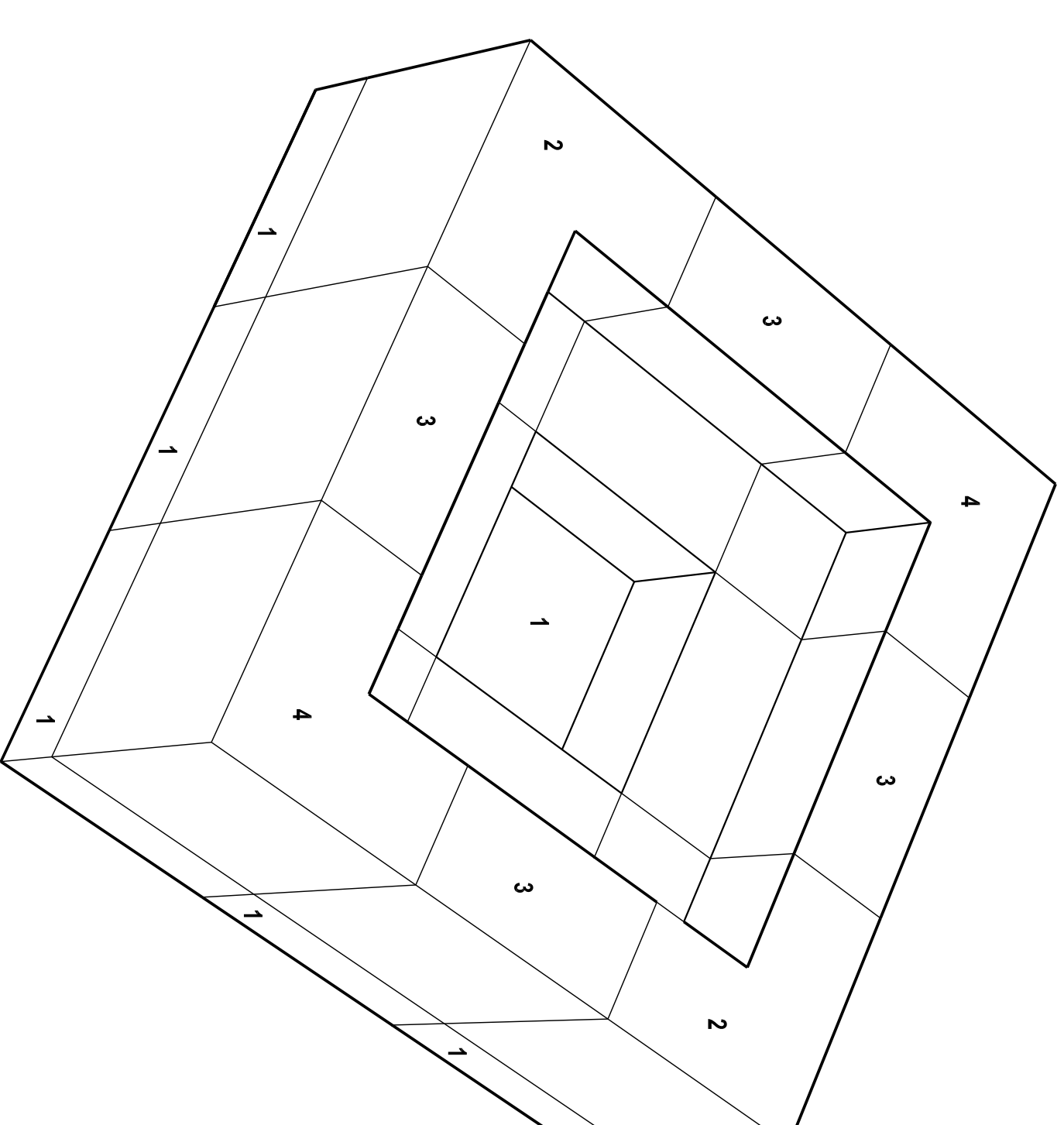

**ISOMETRIC**

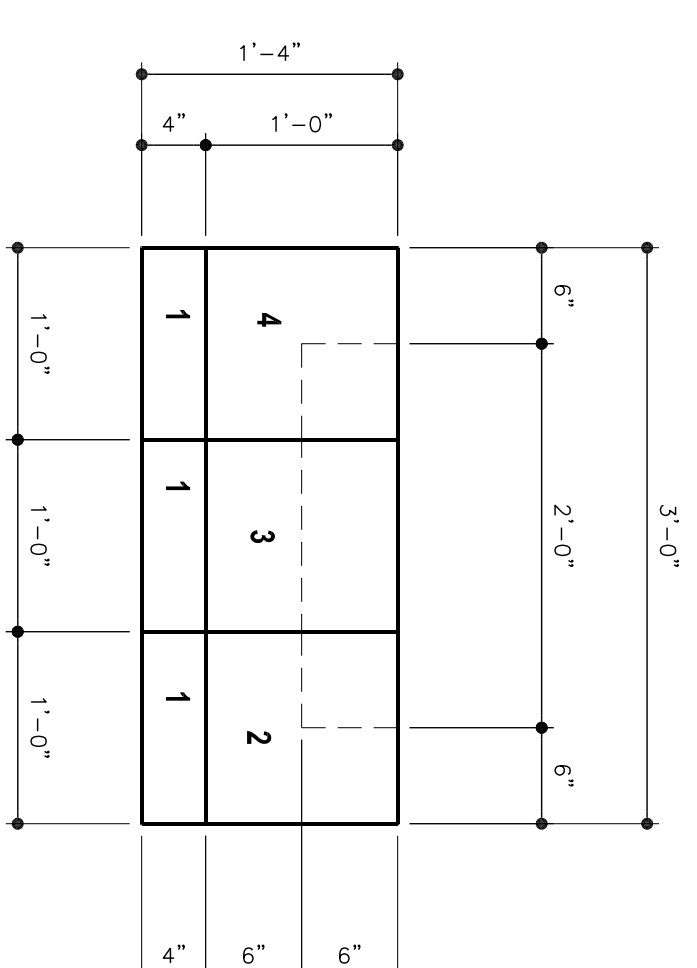

**FIRE PIT ELEVATION**

SCALE: 1" = 1'-0"

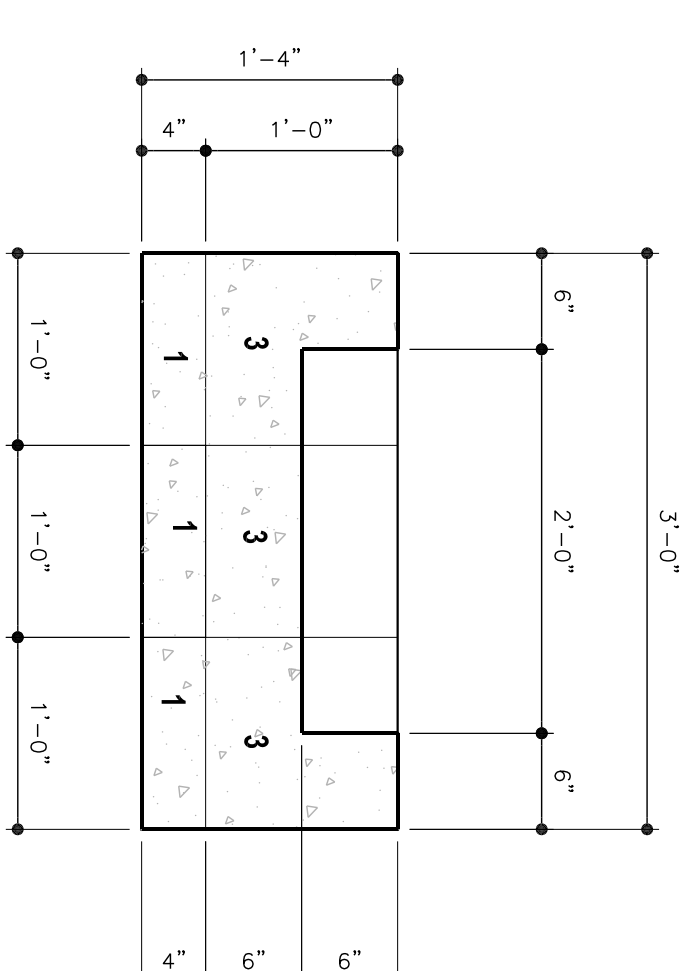

**FIRE PIT SECTION**

SCALE: 1" = 1'-0"

RELEASE DATE

01/16/12

SCALE

1" = 1'-0"

SHEET

SQR-FPIT

# INSTALLATION AND SPECIFICATION PAGE FOR FIRE ROCK FIRE RING

## Site Preparation:

- Generally, a concrete pad 4 – 6 inches thick with footings as dictated by local building codes, is the best surface on which to erect any fire feature.
- With proper ground preparation, such as the gravel and sand layering under a paver patio, a Fire Rock Fire Ring may be installed without a concrete foundation.
- If it is your intention to install this product on a combustible surface (wooden deck), take extra precautions to insulate the surface under and surrounding the Fire Ring so that neither heat transference nor sparks present a hazard.

**Center Base**

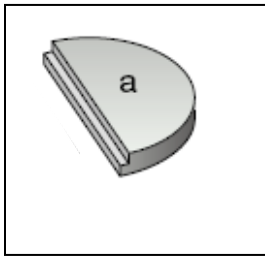

**Riser Block**

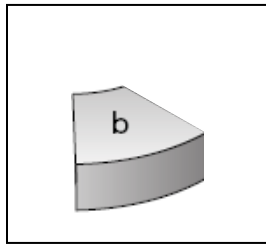

**Fire Ring Block**

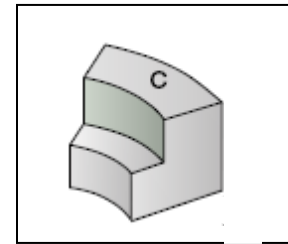

## Specifications:

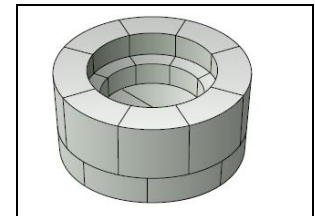
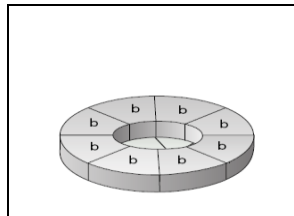
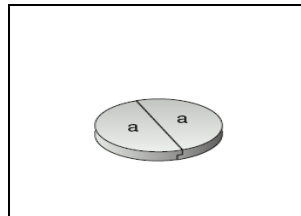
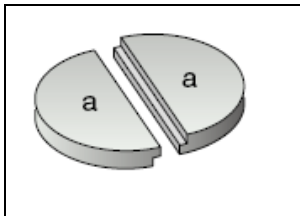
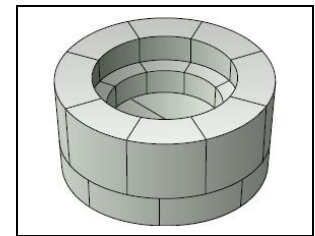
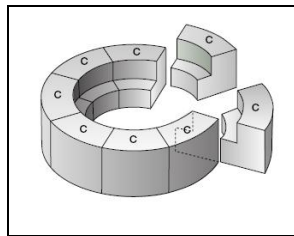
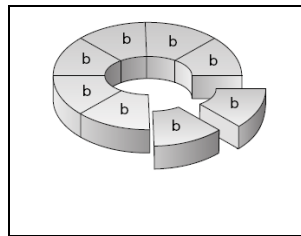
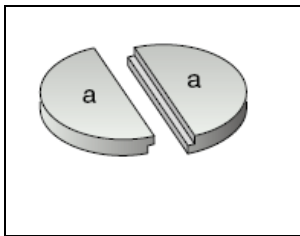
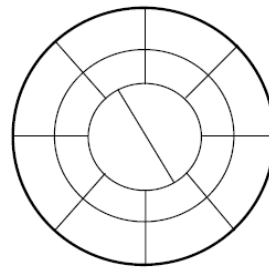
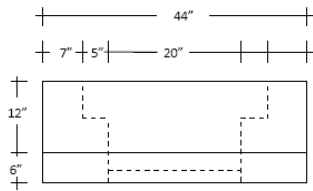

Step 1

Step 2

Step 3

Step 4

Each surface connecting with another surface must be generously covered with Fire Rock Adhesive Mortar.



**Fire Rock Products, LLC**

Birmingham, AL  
(205) 639-5000  
[www.firerock.us](http://www.firerock.us)



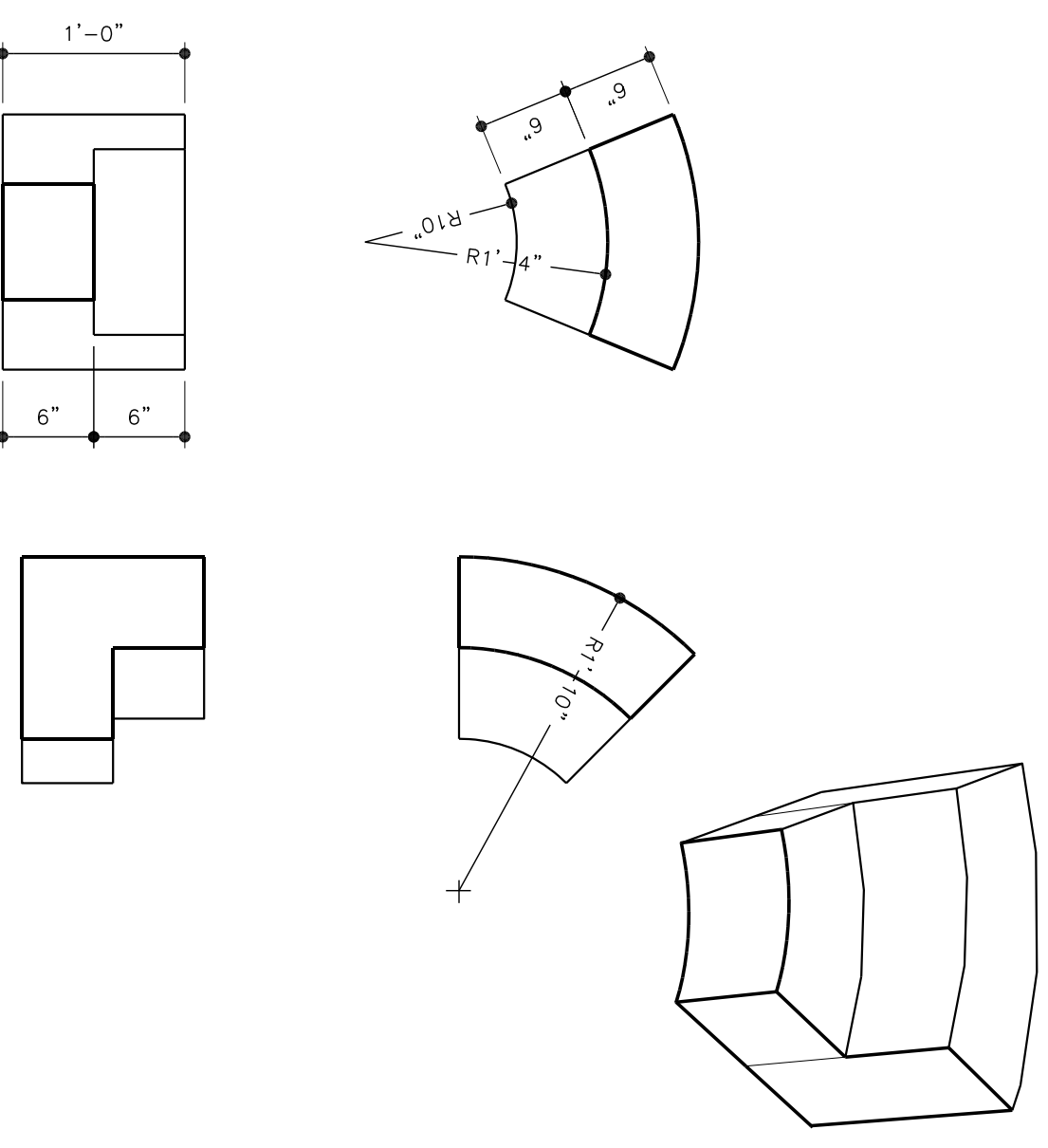

### 3 UNIT BLOCK

#	COMPONENT NAME
1	BASE PLATE
2	INTERMEDIATE BLOCK
3	UNIT BLOCK

### 1 BASE PLATE

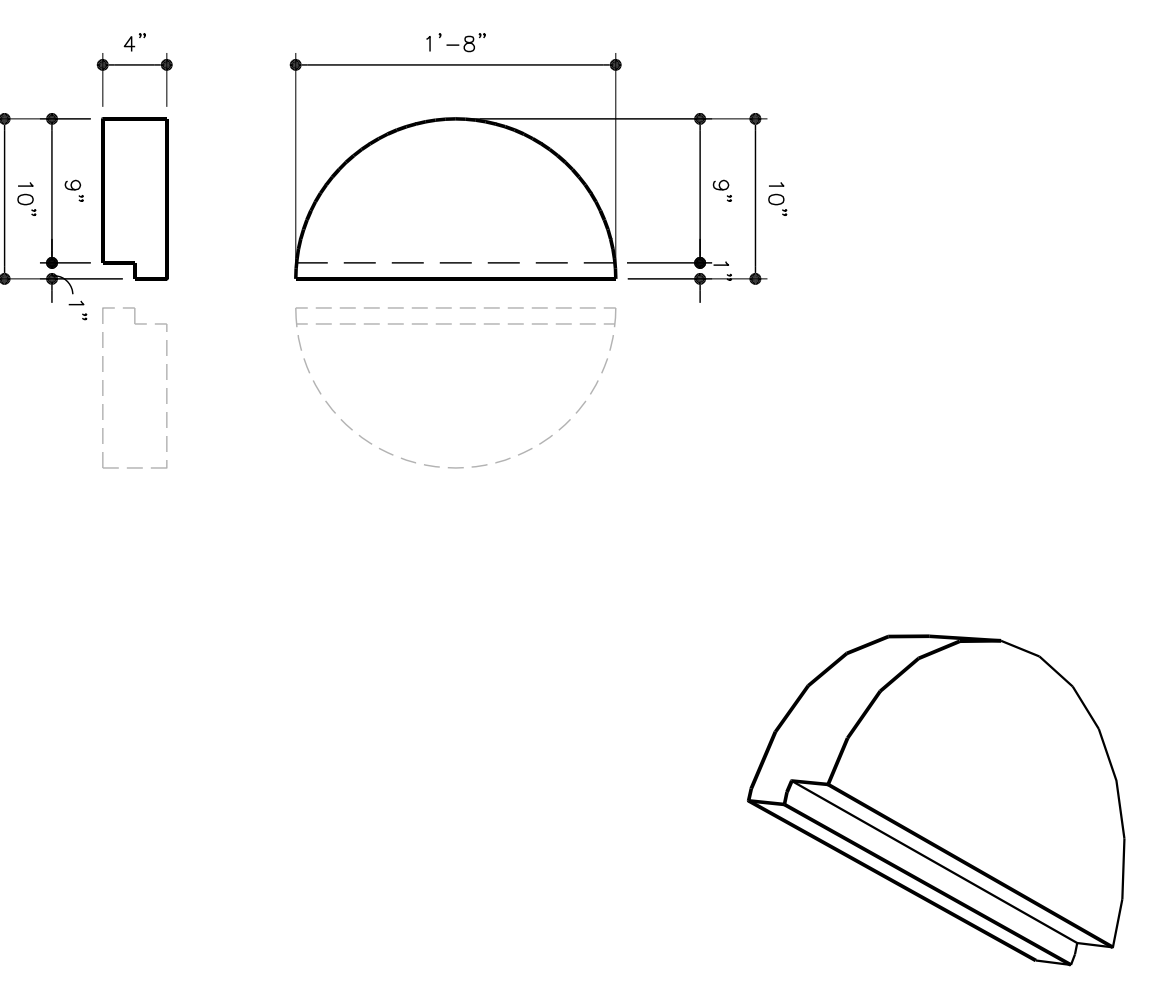

### 2 RISER BLOCK

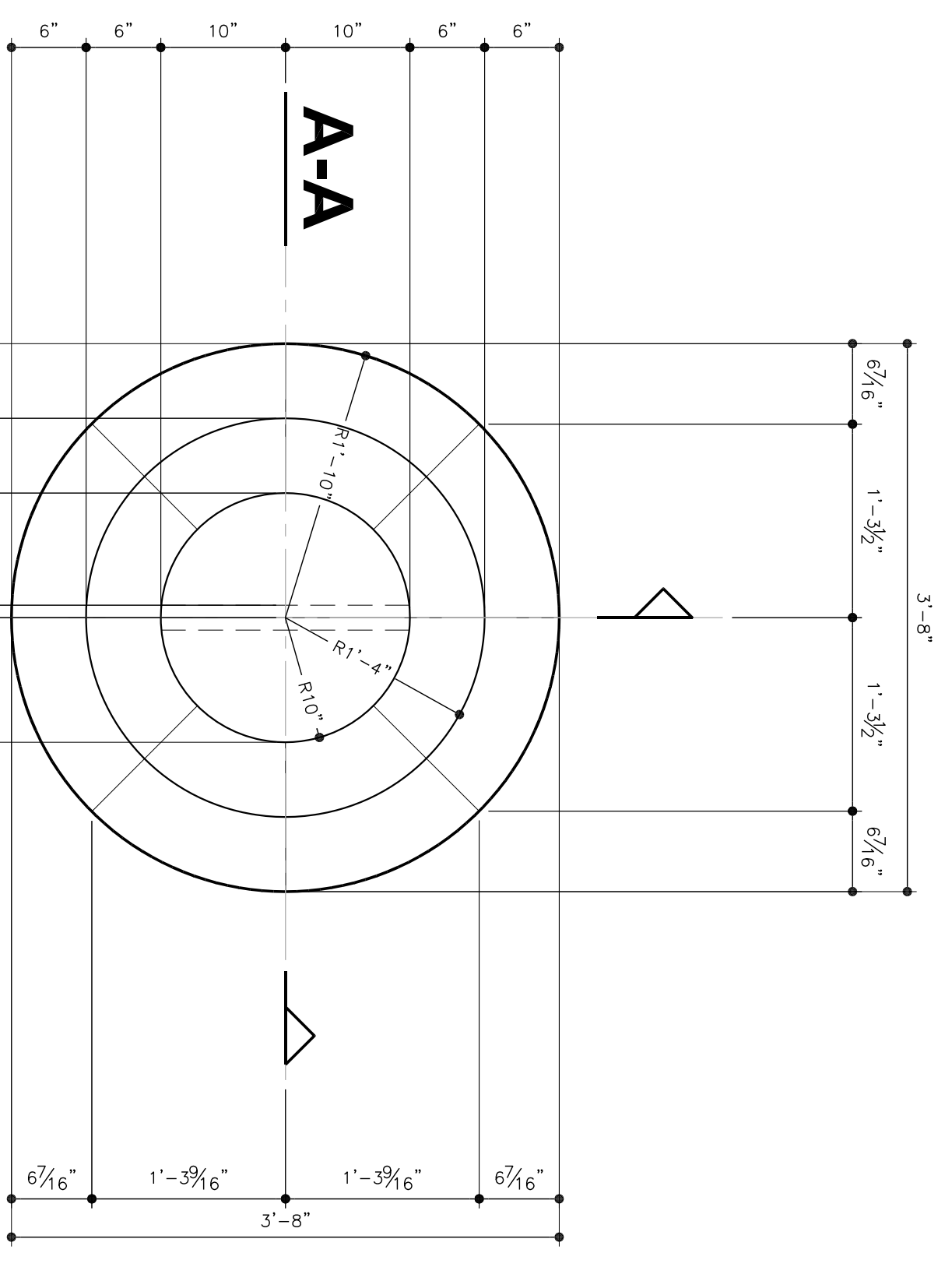
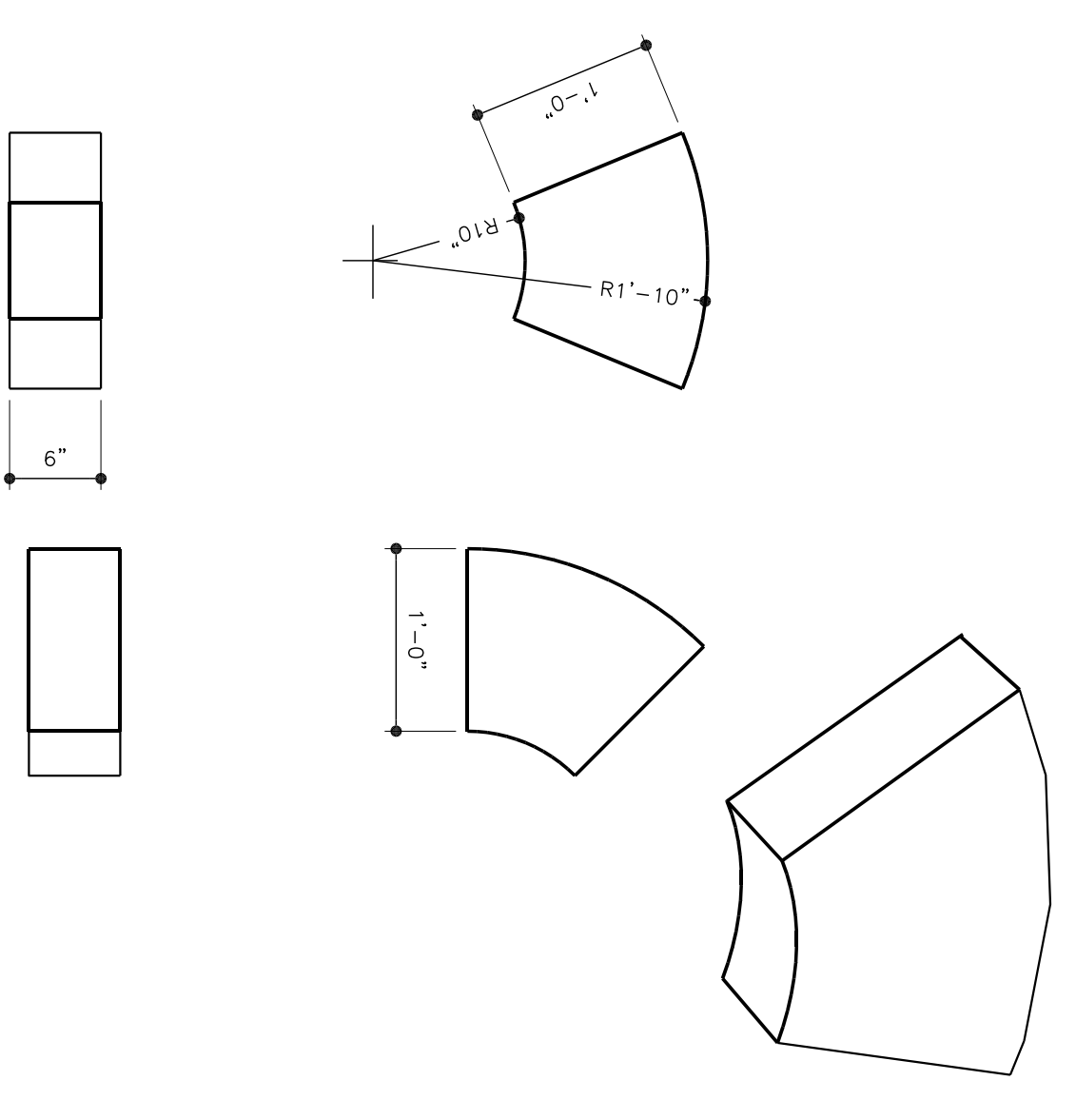

### PLAN

SCALE: 1" = 1'-0"

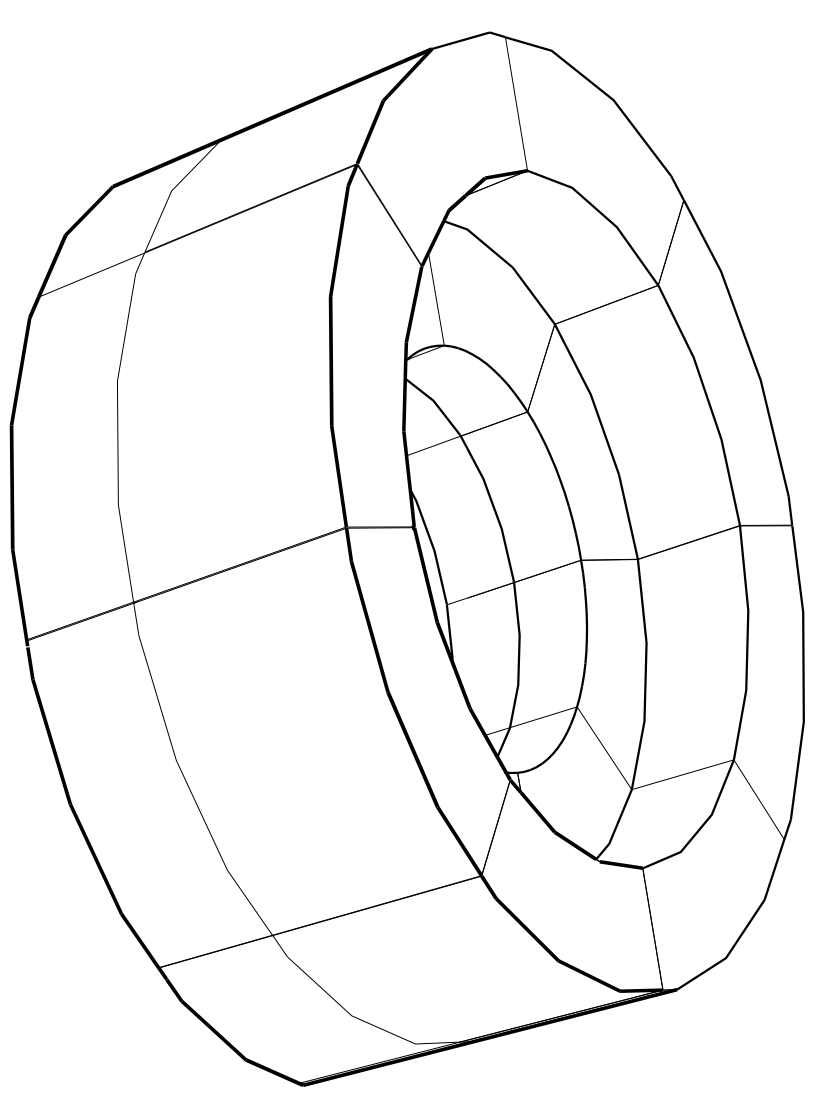

### ISOMETRIC

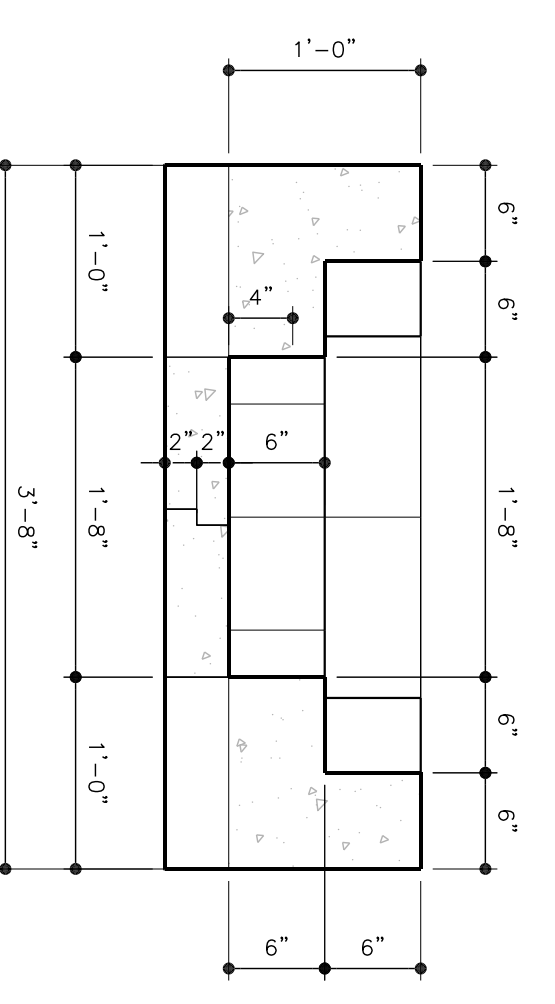

### SECTION A-A

SCALE: 1" = 1'-0"

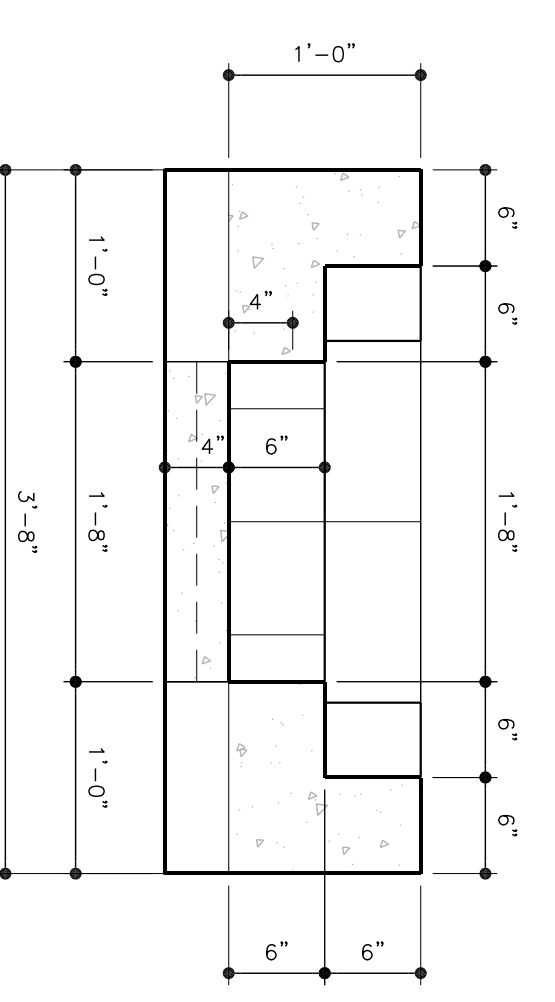

### SECTION B-B

SCALE: 1" = 1'-0"