

# INSTALLATION INSTRUCTIONS FOR TYPE 2 HY-C STOVE BOARD/ FLOOR PROTECTOR / WALL SHIELD / EMBER PROTECTOR



- T2UL2832BL-1
- T2UL3242BL-1
- T2UL3636BL-1
- T2UL3648BL-1
- T2UL3652BL-1
- T2UL4048BL-1
- T2UL2832GT-1
- T2UL3242GT-1
- T2UL3636GT-1
- T2UL3648GT-1
- T2UL3652GT-1
- T2UL4848BL-1
- T2UL2832ST-1
- T2UL3242ST-1
- T2UL3636ST-1
- T2UL3648ST-1
- T2UL3652ST-1
- T2UL2832WW-1
- T2UL3242WW-1
- T2UL3636WW-1
- T2UL3648WW-1
- T2UL3652WW-1

1. The Type 2 HY-C Stove Board / Floor Protector / Wall Shield / Ember Protector is intended for use with UL Listed Solid Fuel Type Room Heater UL 1482, Fireplace Stoves UL 737, Factory-Built Fireplaces UL 127, Fireplace inserts UL 737 and UL1482, and Room Heaters, Pellet Fuel-Burning Type ASTM E1509. The above intended uses follow the UL 1618 Standard. The R-Value of this product is R= 1.56. The R-Value must be equal to or greater than that specified in the heat producing appliance's installation instructions and labeling. This Type 2 Thermal Floor Protector may be used as a Type 1 Ember Protector.

2. Refer to the installation instructions of the UL Listed Solid Fuel Type Room Heater or Fireplace Stove for the minimum floor area requiring protection for the installation of the Listed appliance. The floor protector must be installed in accordance with the instruction manual and local building codes.

3. To join two or more Type 2 HY-C Stove Board / Floor Protector / Wall Shield / Ember Protector side by side, use a HY-C Stove Board Connector Kit (Part # ULCK - sold separately). This kit contains connector clips to join two of the largest HY-C Stove Boards / Floor Protectors / Wall Shields / Ember Protector. (It may be necessary to raise the metal lip of the Type 2 HY-C Stove Board / Floor Protector / Wall Shield / Ember Protector, at the edge only, to start installation of clips. The clips may be gently tapped into place with a hammer.) See Fig. 1. To prevent hot embers or coals from coming into contact with combustible construction below the joined Stove Boards / Floor Protectors / Wall Shields / Ember Protectors, the connector clips, supplied with the HY-C Stove Board Connector Kit (Part # ULCK - sold separately), must be installed according to Type 2 Stove Board / Floor Protector / Wall Shield / Ember Protector instructions so that no combustible construction can become exposed after installation of the Type 2 Stove Board / Floor Protector / Wall Shield / Ember Protector.

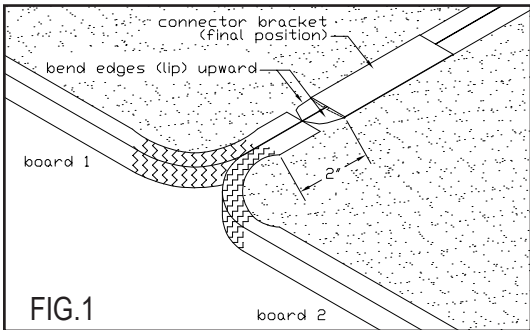

4. For best results, the Type 2 HY-C Stove Board / Floor Protector / Wall Shield / Ember Protector should be installed on a flat solid surface. Carpeting and padding should be removed when the Type 2 Stove Board / Floor Protector / Wall Shield / Ember Protector is installed.

5. The Type 2 HY-C Stove Board / Floor Protector / Wall Shield / Ember Protector must NOT be cut or trimmed.

6. If an electrical blower is being used in conjunction with the UL Listed Fireplace Stove or Solid Fuel Type Room Heater, HY-C Grounding Kit (Part # ULEG - sold separately) is required to ground the Type 2 HY-C Stove Board / Floor Protector / Wall Shield / Ember Protector and electrical blower in accordance with the National Electrical Code. **WARNING: RISK OF FIRE AND ELECTRICAL SHOCK. DO NOT DRILL INTO THE FIRE CHAMBER OR INSTALL THE GROUNDING WIRE IN AN AREA WHERE IT MAY CAUSE TRIPPING OR BE SUBJECT TO DAMAGE.**

7. When using the Type 2 HY-C Stove Board / Floor Protector / Wall Shield / Ember Protector as a wall shield, it is to be installed to provide continuous protection from the floor, at least 3 inches below the ceiling and at least 1 inch above the floor. **\*\*CAUTION\*\*:** Maintain a 3 inch minimum air space between the top of the Wall Shield and the ceiling. When using a Type 2 HY-C Stove Board / Floor Protector / Wall Shield / Ember Protector as a wall shield, as described here, the minimum clearance to the back wall marked on a UL Listed solid fuel room heater, may be reduced by a maximum of 58%, providing the reduced controlling clearance was not less than 12 inches. Controlling clearance is the minimum clearance, which locates that part of the room heater assembly (chimney connector or back of unit) closest to combustible construction. Example: 36 inches required could be 15 inches. See Clearance Reduction Chart. **WARNING: DO NOT ALLOW THE APPLICATION OF COMBUSTIBLE MATERIALS TO THE FACE OF THE HEAT SHIELD.**

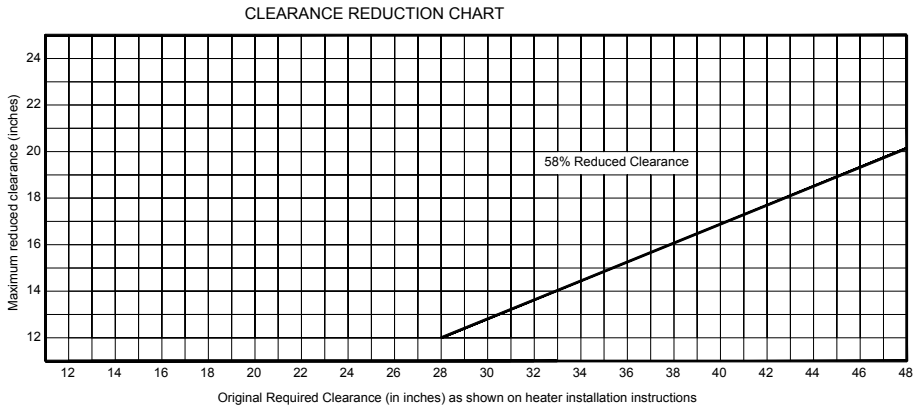

8. When using Type 2 HY-C Stove Board / Floor Protector / Wall Shield / Ember Protector as a wall shield, use the HY-C Installation Kit (Part # ULSK - sold separately) by positioning the boards against the combustible wall to be protected. Hold each board, in turn, flat against the wall in its position, and drill 1/4" holes completely through the board and into the wall behind. See hole pattern in Fig. 2.

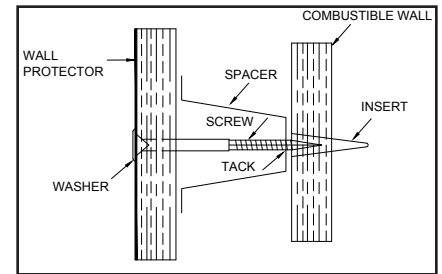
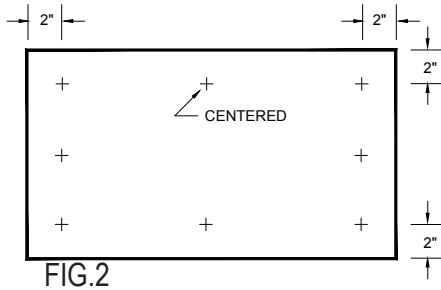

9. After holes are drilled, remove board and put plastic inserts into holes in the wall. See Fig. 3.

10. Tack the metal spacers in position through holes provided, directly over each insert, using carpet tacks included in kit.

11. Replace board in position against spacers and screw in place using screws and washers provided. Do not over tighten.

12. For the area to be covered for your installation see sketches below. The coverage areas are minimum.

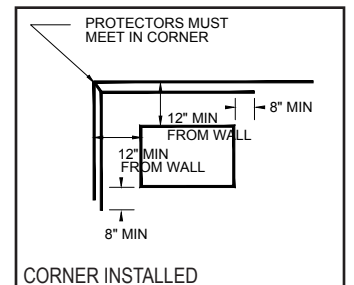
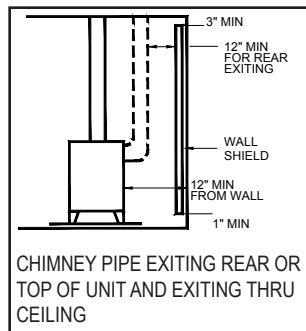
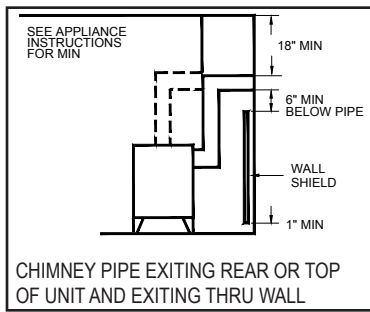
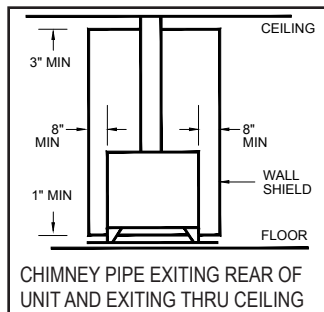

## SINGLE WALL PROTECTED