



CRD36, CRD42

Contemporary Rectangular Design Decorative Fronts

Installation Instructions for all available color choices



Leave this manual with party responsible for use and operation.

CAUTION! Risk of Cuts, Abrasions or Flying Debris.
Wear protective gloves and safety glasses during installation. Sheet metal edges are sharp.



**HOT GLASS WILL
CAUSE BURNS.**

**DO NOT TOUCH GLASS
UNTIL COOLED.**

**NEVER ALLOW CHILDREN
TO TOUCH GLASS.**

A barrier designed to reduce the risk of burns from the hot viewing glass is provided with this appliance and must be installed for the protection of children and other at-risk individuals.

WARNING! Risk of Fire! Combustible materials **MUST NOT** overlap or be placed behind a decorative front.

CAUTION! Do not install damaged components.

Note: To avoid potential damage to hearth pad or flooring, protect area in front of fireplace by laying cardboard or blanket down.

INTRODUCTION

This instruction is to be used for both Inside Fit and Overlap Fit for both sizes of the Contemporary Rectangular Design (CRD) decorative fronts. Multiple color options are available.

A. Finishing Material

Refer to Table 1 for Decorative Front dimension information.

These decorative fronts are designed to be installed as “Overlap” or “Inside Fit”.

Overlap Method: The factory-installed finishing strips are to be removed for this method of finishing. Non-combustible finish material that is 1” or less (such as marble or tile) is installed up to the fireplace opening on the sides and top. The mounting brackets are adjusted “out” so that the edges of the mounting brackets are flush with the face of the finishing material. When installed, the back of the decorative front contacts the face of the finish material, thus the decorative front “overlaps” the finish material. Refer to the appliance installation instructions for more detailed information.

Inside Fit Method: The factory-installed finishing strips are to remain in place during installation of the finishing material. Typically, the inside fit method is only used when non-combustible finish material greater than 1” is preferred (such as cultured stone). This finish material is installed adjacent to the decorative front sides and top. The mounting brackets are to be installed “flush” with the black edges of the inside surround opening. See Figure 3. When installed, the back of the decorative front contacts the black surround on the fireplace, thus the decorative front is “inside” the adjacent finish material. Refer to the appliance installation instructions for more detailed information.

DECORATIVE FRONT	HEIGHT	WIDTH
CRD36	32-3/8 IN.	37-1/16 IN.
CRD42	34-1/4 IN.	44-1/16 IN.

Table 1. Decorative Front Dimensions

B. Installation

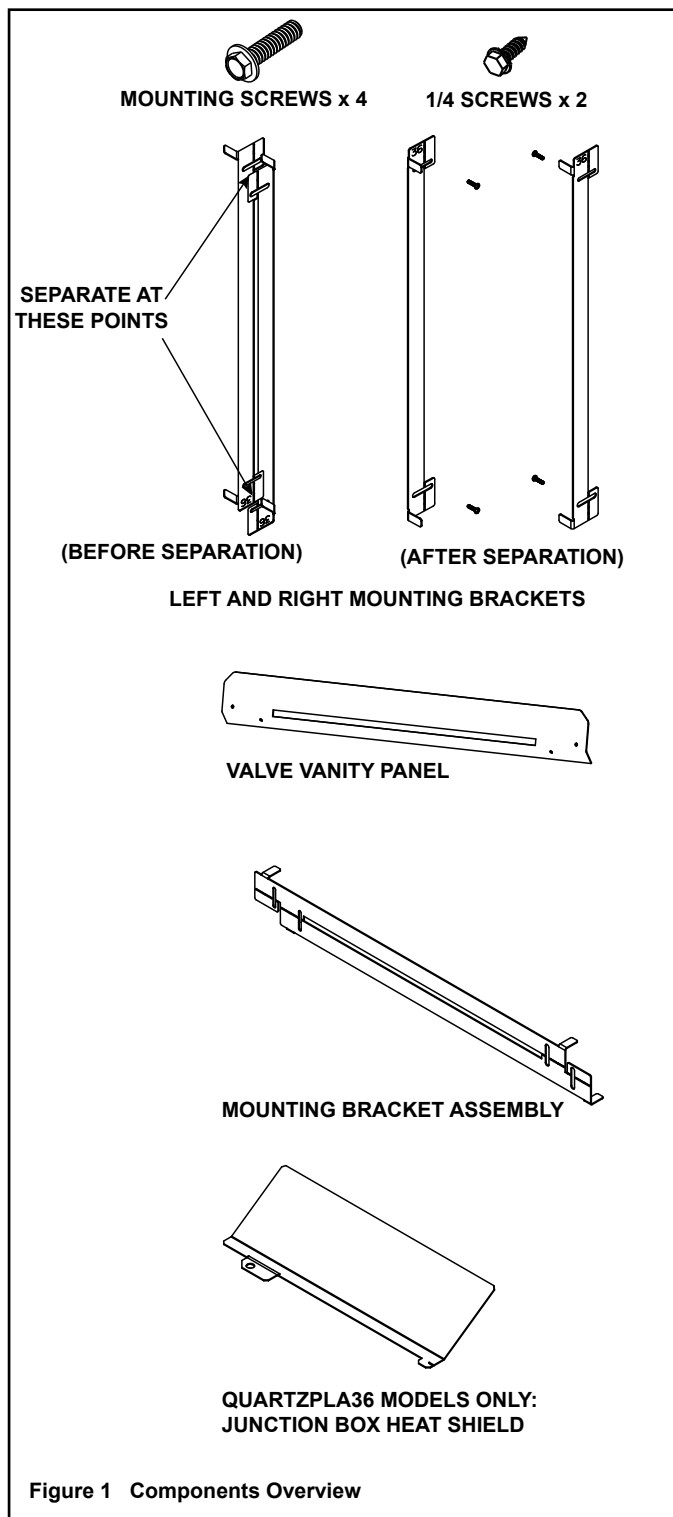

1. Remove mounting bracket assembly and bend the mounting bracket assembly vertically to separate the left and right brackets. See Figure 1.
2. If the factory-installed finishing strips attached to the surround of the fireplace were not removed during the installation of finishing material, remove them by removing the four screws located on each of the two sides and the top using a 1/4 in. nut driver and discard screws.

3. Attach mounting brackets to appliance using the four mounting screws. Locate the laser-cut number (36 or 42) on the bracket which represents the size of the decorative front. This marking also indicates the top of the bracket. Install the bracket so that the front edge of the bracket needs to sit flush with the desired depth of the decorative front. See Figure 3.

For example: If the decorative front is to fit tight against the appliance (Inside Fit), install the brackets flush with the face of the appliance. If the decorative front is to fit up tight against a finishing material with maximum thickness of one inch (Overlap Fit), the brackets should be flush with the face of the material. Refer to Section 10 of appliance installation manual for more information.

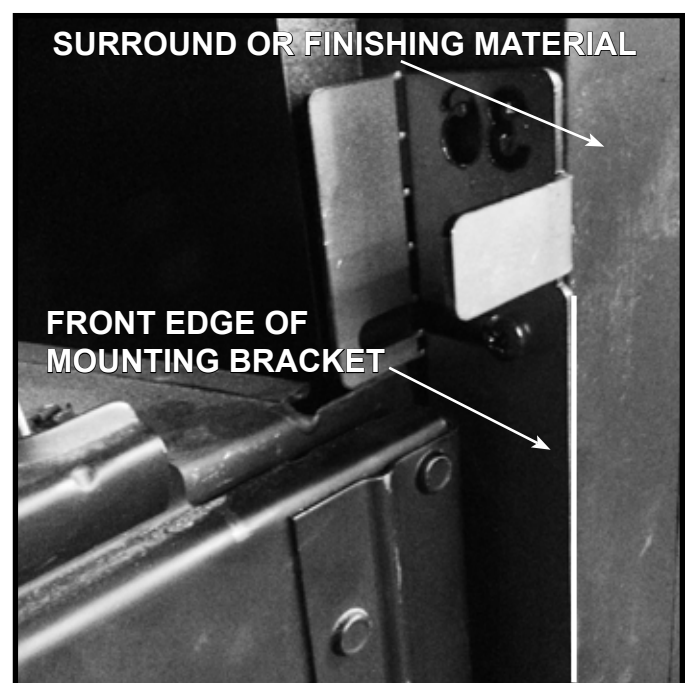
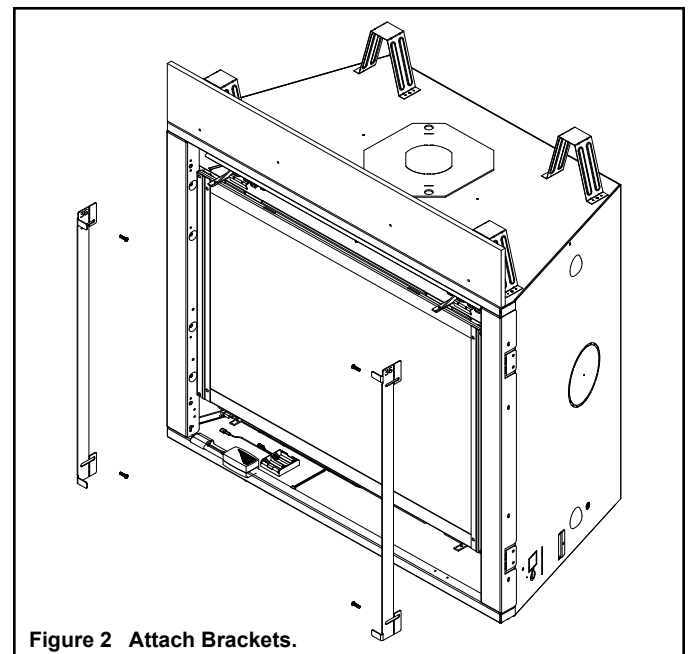
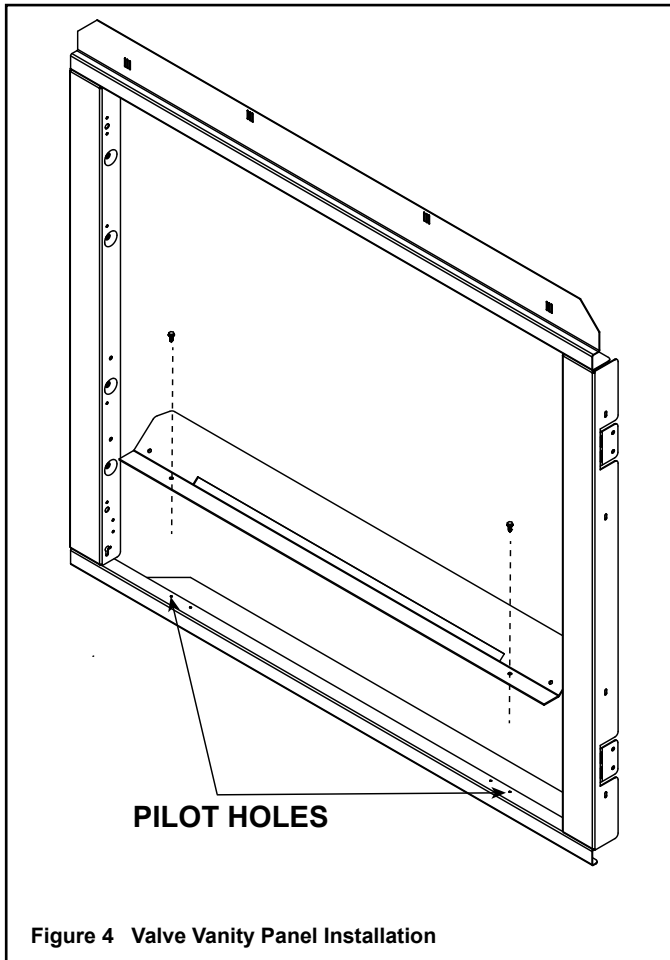

Figure 3 Attach Mounting Brackets

4. Remove valve vanity panel and manual bag from packaging.
5. Install valve vanity panel to pilot holes located on the bottom rail with two screws as shown in Figure 4.



QUARTZPLA36IN/QUARTZPLA36IL REQUIREMENT

For all other models, proceed to Step 6.

CAUTION! Risk of Overheating! Junction box heat shield **MUST** be installed before operating appliance. Electrical components will be damaged.

QUARTZPLA36IN / QUARTZPLA36 IL:

Locate the Junction Box Heat Shield included with the decorative front. Bend the hand bend feature approximately 90° as shown in Figure 5. Install above the fire-place junction box by inserting the hook feature into the space above the junction box mounting slot. The hand bent tab then slides behind the junction box tab while the hook engages the fireplace outer-shell. Final heat shield placement should be as shown in Figure 6.

QUARTZPLA36IN / QUARTZPLA36IL REQUIREMENT

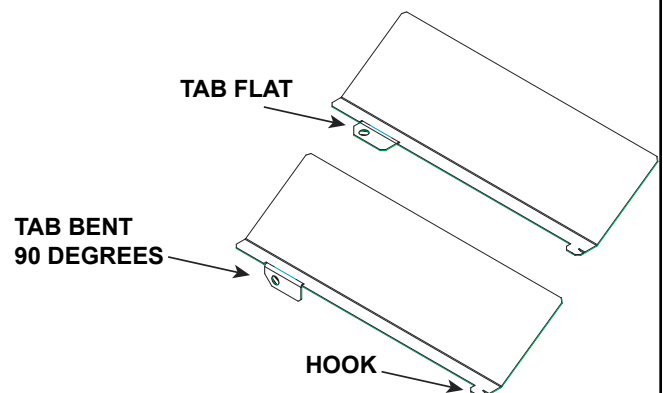

Figure 5 Junction Box Heat Shield - Bend Tab

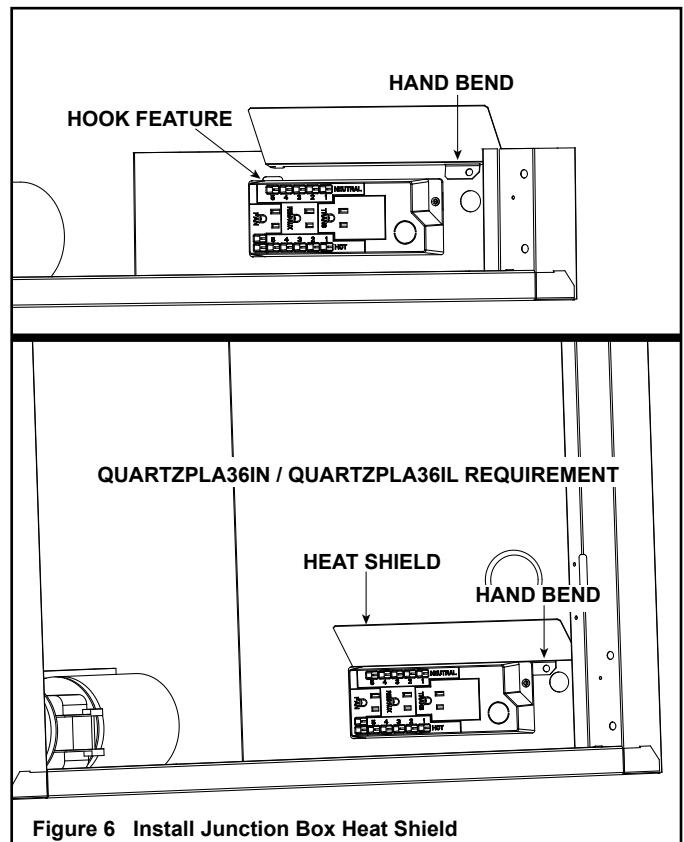

Figure 6 Install Junction Box Heat Shield

6. Install the decorative front to the mounting brackets by engaging the brackets mounted on the decorative front assembly to the mounting brackets located on the appliance. See Figure 7. Ensure the decorative front is properly attached and securely positioned on the appliance.

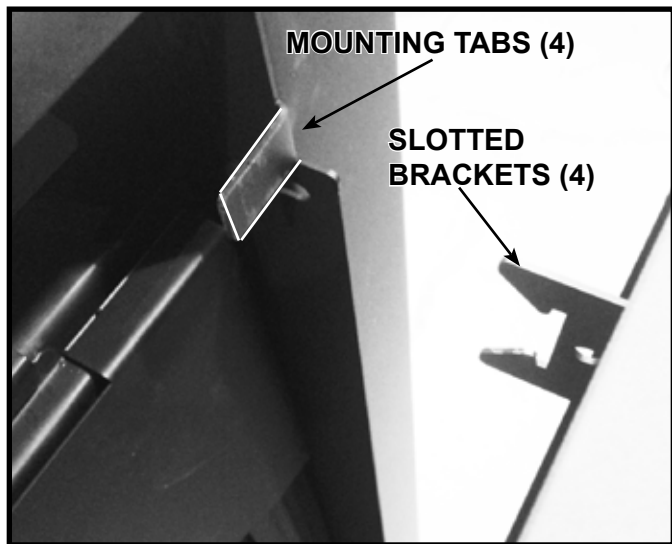

Figure 7 Install Decorative Front

Cleaning Instructions for Decorative Fronts

Use a microfiber cloth and Windex® Original Glass Cleaner or 03M003 Stove Bright® Glass Cleaner to clean the decorative front immediately after installation to remove acids deposited by the installer or technician. Spray the cleaner onto the microfiber cloth and carefully wipe the entire surface. The decorative front should be cleaned in this manner annually by the homeowner to remove fingerprints or other contaminants. Once oxidation of the paint pigment has occurred, cleaning will not restore the original color.

Please contact your Majestic dealer with any questions or concerns.

For the location of your nearest Majesticdealer, please visit www.majesticproducts.com.

Majestic, a brand of Hearth & Home Technologies
7571 215th Street West, Lakeville, MN 55044
www.majesticproducts.com