

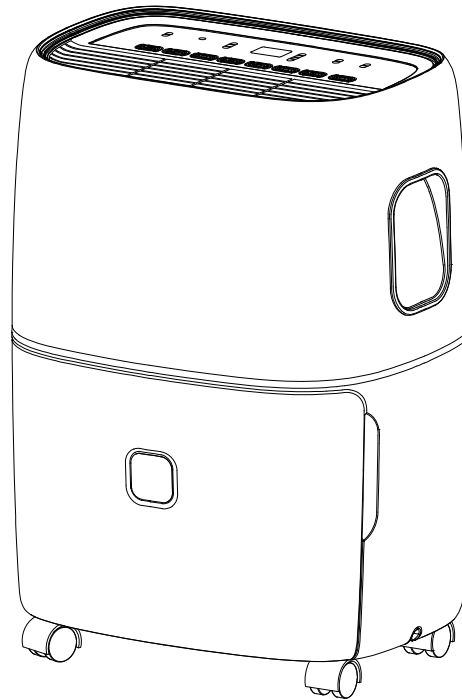

OWNER'S MANUAL
DEHUMIDIFIER



MODEL:SD-53E/SD-54PE

Thank you for selecting our quality appliance.
Please be sure to read this user manual carefully before using.
Any question, please contact the professional service for help.



CONTENTS

IMPORTANT SAFEGUARDS	01
IMPORTANT - GROUNDING METHOD	02
ELECTRICAL CONNECTIONS	02
SOME NOTIONS ON HUMIDITY	03
PRODUCT OVERVIEW	04
OPERATION	06
AUTOMATIC DEFROST	11
LOCATION REQUIREMENTS	11
CLEAN AND MAINTENANCE	11
CLEAN THE DEHUMIDIFIER	12
CLEAN THE FILTER	12
END OF SEASON OPERATIONS	12
START OF SEASON CHECKS	12
TROUBLESHOOTING	13
ERROR CODES	15

IMPORTANT SAFEGUARDS

- Disconnect the appliance from its power source during service and when replacing parts and cleaning.
- Please note: Check the rating label for the type of refrigerant gas used in your appliance.
- Specific information regarding appliances with refrigerant gas.

The appliance is recommended not to pierce the cooling circuit of the machine. At the end of its useful life, deliver the appliance to a special waste collection center for disposal. GWP(Global Warming Potential): R410A: 2088, R134a: 1430, R290: 3, R32: 675.

- This hermetically sealed system contains fluoridated greenhouse gases.
- ENVIRONMENTAL INFORMATION: This unit contains fluoridated greenhouse gases covered by the Kyoto Protocol.
- Do not use this unit for functions other than those described in this instruction manual.
- Make sure the plug is plugged firmly and completely into the outlet. It can result in the risk of electric shock or fire.
- Do not plug other appliances into the same outlet, it can result in the risk of electric shock or fire.
- Do not disassemble or modify the appliance or the power cord, it can result in the risk of electric shock or fire. All other services should be referred to a qualified technician.
- Do not place the power cord or appliance near a heater, radiator, or other heat source. It can result in the risk of electric shock or fire.
- This unit is equipped with a cord that has a ground wire connected to an earthed pin or grounding tab. The plug must be plugged into a socket that is properly installed and grounded. Do not under any circumstances cut or remove the earthed pin or grounding tab from this plug.
- The unit should be used or stored in such a way that it is protected from moisture e.g. condensation, splashed water, etc. Unplug unit immediately if this occurs.
- Always transport your appliance in a vertical position and place on a stable, level surface during use. If the unit is transported lying on its side it should be stood up and left unplugged for 6 hours.
- Always use the switch on the control panel or remote control to turn the unit off, and do not start or stop operation by plugging in or unplugging the power cord. It can result in the risk of electric shock.
- Do not touch the buttons on the control panel with wet and damp fingers.
- Do not use hazardous chemicals to clean or come into contact with the unit. To prevent damage to the surface finish, use only a soft cloth to clean the appliance. Do not use wax, thinner, or a strong detergent. Do not use the unit in the presence of inflammable substance or vapour such as alcohol, insecticides, gasoline, etc.
- If the appliance is making unusual sounds or is emitting smoke or an unusual odor, unplug it immediately.
- Do not splash water on the unit or immerse the unit in water. Water can enter the unit and damage the insulation and create electric shock hazard. If water enters the unit, unplug it immediately and contact Customer Service.
- Utilize two or more people to lift and install the unit.

IMPORTANT SAFEGUARDS

- Always grasp the plug when plugging in or unplugging the appliance. Never unplug by pulling on the cord. It can result in the risk of electrical shock and damage.
- Install the appliance on a sturdy, level floor capable of supporting up to 110lbs (50kg). Installation on a weak or uneven floor can result in the risk of property damage and personal injury.

IMPORTANT - GROUNDING METHOD

This product is factory equipped with a power supply cord that has a three-pronged grounded plug. It must be plugged into a mating grounding type receptacle in accordance with the National Electrical Code and applicable local codes and ordinances. If the circuit does not have a grounding type receptacle, it is the responsibility and obligation of the customer to exchange the existing receptacle in accordance with the National Electrical Code and applicable local codes and ordinances. The third ground prong should not, under any circumstances, be cut or removed. Never use the cord, the plug or the appliance when they show any sign of damage. Do not use your appliance with an extension cord unless it has been checked and tested by a qualified electrical supplier. Improper connection of the grounding plug can result in risk of fire, electric shock and/or injury to persons associated with the appliance. Check with a qualified service representative if in doubt that the appliance is properly grounded.

ELECTRICAL CONNECTIONS

Before plugging the appliance into the mains socket, check that:

- The mains power supply corresponds to the value indicated on the rating label on the back of the appliance.
- The power socket and electrical circuit are adequate for the appliance.
- The mains socket matches the plug. If this is not the case, have the plug replaced.
- The mains socket is adequately grounded. Failure to follow these important safety instructions absolves the manufacturer of all liability.

This appliance is not intended for use by persons (including children) with reduced physical, sensory or mental capabilities, or lack of experience and knowledge, unless they have been given supervision or instruction concerning use of the appliance by a person responsible for their safety.

- Children should be supervised to ensure that they do not play with the appliance.
- If the POWER CORD is damaged, it must be replaced by the manufacturer or licensed electricians in order to avoid a hazard.
- The appliance shall be installed in accordance with national wiring regulations.

SOME NOTIONS ON HUMIDITY

Air always contains a certain amount of water in the form of vapor. This determines the level of humidity in an atmosphere. The capacity of the air to hold water vapor increases with temperature. This is why in our homes, as soon as the temperature decreases, the vapor contained in the air condenses, as is evident on the colder surfaces in the room, such as the windows, walls etc. The purpose of a dehumidifier is to remove the excess moisture from the air, avoiding the damage caused by condensation.

Experts have established that the optimum environmental conditions for our well-being and for the home are obtained between 40% and 60% relative humidity. With very low temperatures, you are recommended to heat the room even minimally. This considerably increases the dehumidifying power of the appliance. With heating, the condensation formed by the water vapor on windows and other cold surfaces evaporates into the air to be collected by the dehumidifier. Air leaving the dehumidifier is usually about 2°-4°F warmer than room temperature.

PRODUCT OVERVIEW

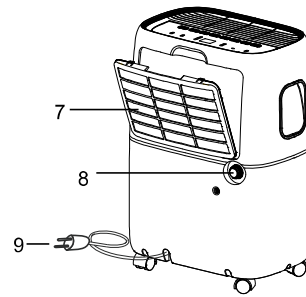
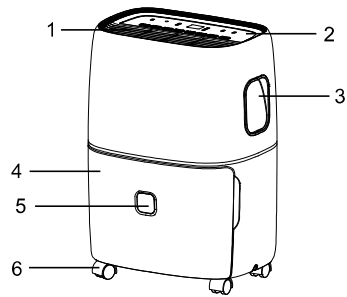

COMPONENT DESCRIPTION

- | | |
|----------------------------|----------------------|
| 1. Air outlet | 6. Casters |
| 2. Control panel | 7. Air intake grille |
| 3. Handle | 8. Drainage hole |
| 4. Bucket | 9. Power cord |
| 5. Water level view window | |

Note: All the illustrations in this manual are for explanatory purposes only. Your appliance may be slightly different.

ACCESSORIES

Before use, remove the accessories from the bucket

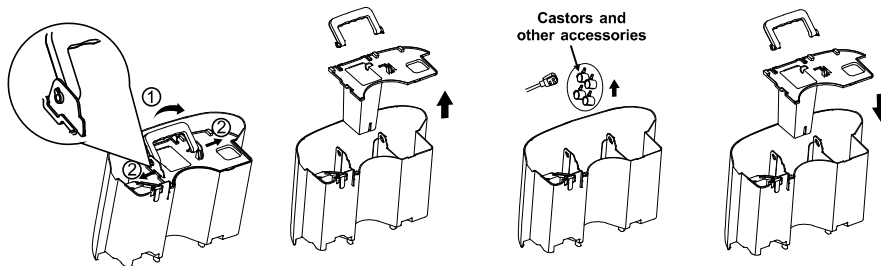

- Remove the bucket, rotate the handle to the position like illustrations below, and remove the handle;
- Remove the cover, take out of the accessories.
- Re-install the cover and handle, correctly put back the bucket into the unit.



PRODUCT OVERVIEW

THE ACCESSORIES INCLUDE:

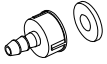
(Note: The accessories are either in the packaging or the bucket.)

	Castors	4 pcs	
	Pump drain connector and gasket	1 set	For Model No. SD-54PE only.
	Pump drain pipe (about 16.4 feet)	1 set	

INSTALL THE CASTORS

Tilt the unit no more than 45° and forcibly insert the casters.

Make sure the plate of the castors is flush against the bottom of the unit.

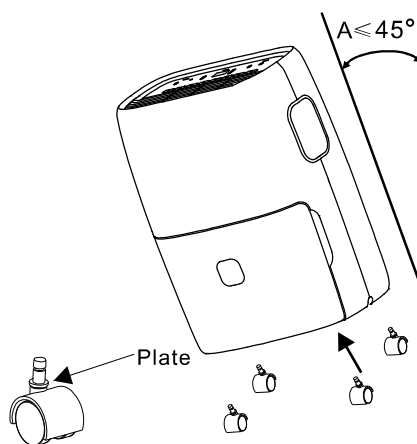

OPERATION

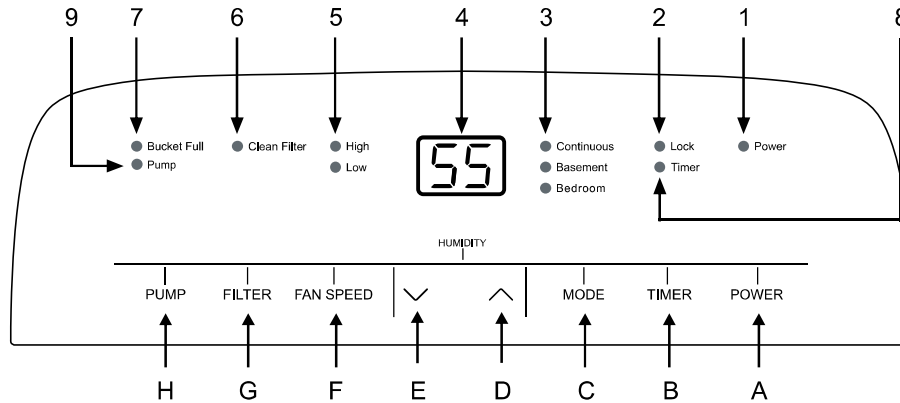

- | | |
|---------------------------|--------------------------------------|
| 1.Power indicator | A.Power(On/Off) button |
| 2.Lock indicator | B.Timer button |
| 3.Pre-set mode indicators | C.Mode button |
| 4.Display screen | D.Increase button |
| 5.Fan speed indicators | E.Decrease button |
| 6.Clean Filter indicator | F.Fan speed button |
| 7.Bucket Full indicator | G.Filter Reset |
| 8.Timer indicator | H.Pump button * |
| 9.Pump indicator * | (* Note: For Model No.SD-54PE only.) |

Insert the plug in the socket, the unit goes to stand-by, and the screen display as the illustration shown:



● “ POWER ” button

On / off power supply, used to control the start-up or shut down the appliance.

● Decrease / Increase button

Press “ ∨ ”/“ ∧ ”to select the indoor humidity level you expect the dehumidifier to achieve, or set the timer.

Adjustable humidity range is 35%RH-80%RH. The screen will display the setting humidity, and turn to display the ambient humidity after a few seconds.

When the ambient humidity is lower than setting humidity, the compressor stops running and the fan stop running after a few minutes.

Continuous mode: Press the “ ∨ ”button until the “ [] ” on screen and “Continuous” indicator lights up, and then the unit will continuously run.

OPERATION

● Fan speed button

Press the “ FAN SPEED ” button to select the fan speed: High or Low. And the corresponding indicator lights up.

● Timer button

This timer can be used to delay the appliance start-up or shutdown. This avoids wasting electricity by optimizing operating periods.

● Programming start-up

1. Turn on the appliance, choose the mode you want. For example, Dehumidify mode and high fan speed. Turn off the appliance.
2. Press the “ TIMER ” button , the “ Timer ” symbol starts to flash, press the “ √ ” / “ ^ ” to adjust the set time from 0.5-24 hours.
3. In 5 seconds without the operation, the timer starts function and then the “ Timer ” indicator lights up.
4. Press the “ TIMER ” button again to cancel the Timer, and the “ Timer ” indicator disappears.

● Programming shut down

1. When the appliance is running, press the “ TIMER ” button and the “ Timer ” symbol starts to flash. Press the “ √ ” / “ ^ ” to adjust the set time from 0.5-24 hours.
2. In 5 seconds without the operation, the timer starts function and then the “ Timer ” indicator lights up.
3. Press the “ Timer ” button again to cancel the Timer, and the “ Timer ” indicator disappears.

● Pre-set mode

Pre-set mode allows the user to easily move the appliance room-to-room and select the corresponding mode for the location in which the appliance operating for optimum performance. Press the “ MODE ” button to choose from Continuous, Basement or Bedroom.

Humidity of Pre-set mode:

- Continuous: The setting humidity is 15%RH
- Basement: The setting humidity is 45%RH
- Bedroom: The setting humidity is 55%RH

● Clean filter

1. When the filter needs to be cleaned, the “ CLEAN FILTER ” indicator will light up (after 250 hours of use). Remove the filter from the back of the unit by following the “ CLEAN THE FILTER ” section.
2. Once the filter is cleaned and completely dry, place the filter back in the unit and press the “ FILTER ” button to reset the filter timer.

Caution: Do not operate the appliance without the included filter.

OPERATION

• Child lock

1. To lock the control panel, press and hold the "Timer" button for 3 seconds. Locking the control panel prevents someone from accidentally changing the settings. When it's locked, the "LOCK" indicator will light up.

2. Press and hold the "Timer" button for 3 seconds to unlock the control panel.

• Bucket full

1. When bucket is full, the compressor will shut off first. The fan will stop in a few minutes, and makes a beeping noise with "Bucket Full" indicator flashing.

2. The unit will not run again until the bucket is emptied and properly placed back to the unit.

3. The bucket should be cleaned every week to prevent the growth of mold, mildew or bacteria. Use a mild detergent to clean the bucket. Once cleaned, completely dry the bucket and place it back to the unit.

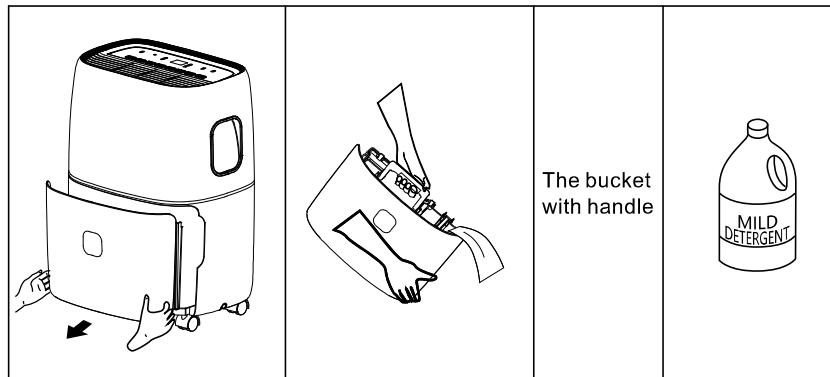

Note: Hold the bucket with both hands when emptying water.

Note: When the bucket is full or removed from the unit, the compressor will turn off but the fan will continue to run for a few minutes. This is completely normal. The unit will not be removing moisture from the air during this time.

Note: During operation, it is normal for the unit to exhaust warm air from the top of the unit.

Caution: Do not place the bucket on the floor when it is full as it is uneven on the bottom and water may spill.

OPERATION

• Continuous drain

Connect the garden hose on the back of unit, and then the unit can continuous run without emptying the bucket.

- 1) Put the unit on level floor, unscrew the cap on the drainage hole;
- 2) Install the garden hose (which has an outer diameter of 1 1/16 inches, or 27.0mm, and a pitch of 11.5 TPI) on unit;
- 3) Press "POWER" button to run the unit.

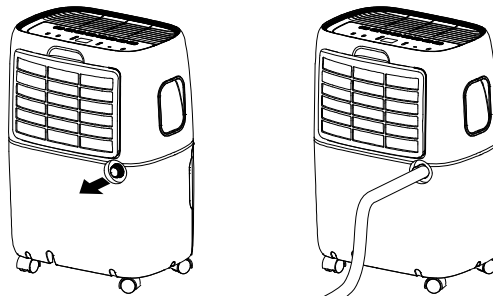

Garden Hose

Note: Please install the garden hose by following the pictures below.

Please install the garden hose correctly, or the water cannot be drained from the hose.

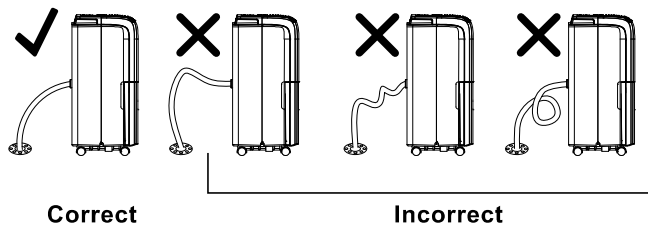

Correct

Incorrect

Notice: If the unit is put on the un-level ground or the garden hose is not installed properly, the water will fill the bucket and stop run once the bucket is full. If that happens, please check the ground is horizontal, and the garden hose is correctly installed. At the same time, the bucket needs to be installed correctly.

CONTROL PANEL

• Pump drain (Model No. SD-54PE only)

Connect the pump drain pipe (5m or 16.4ft) on the back of the unit, and then the unit can continuous run without emptying the bucket.

- 1) Put the unit on level floor and unscrew the cap on the drainage hole;
- 2) Install the pump connector and gasket;
- 3) Install the drain pipe on connector;
- 4) Press "POWER" button to run the unit and press the "PUMP" button to start the pump drain function The "PUMP" indicator lights up.
- 5) The max. height of pump drainage is 5 meters (16.4 ft) ;

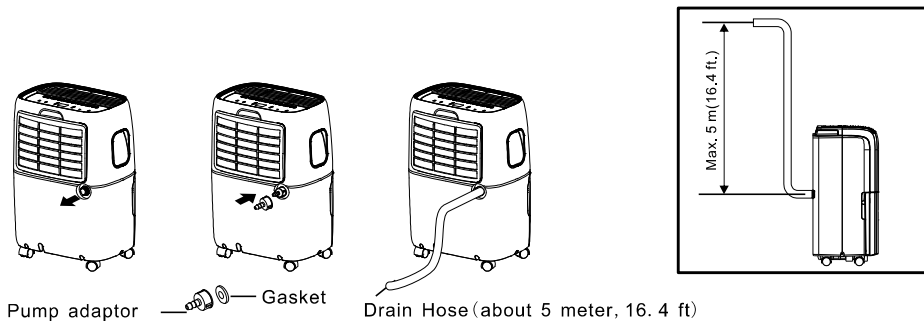

Note: After pump function has been activated, pump will not begin removing water immediately. The pump will remain on stand-by. When bucket is almost full, pump will automatically begin removing water and stop after 4 mins. This cycle will continue until pump function is deactivated. Make sure there are no kinks or knots in the hose.

AUTOMATIC DEFROST

When frost builds up on the evaporator coils, the compressor will stop and the fan will continue to run until the frost disappears. When the coils are completely defrosted, the compressor will automatically restart and dehumidifying function will resume.

LOCATION REQUIREMENTS

The unit operating in a room will have little or no effect on dehumidifying any adjacent enclosed space, such as a closet, unless there is adequate air circulation in and out of the enclosed space.

1. Do not use outdoors.
2. This appliance is intended for indoor use only. Place the appliance on a level surface that is strong enough to support the unit with a full bucket of water.
3. Allow at least 18" (45cm) of space around and above away from the wall for sufficient air circulation.
4. Place the appliance in an area where the temperature will not fall below 5°C(41°F).
5. Use the dehumidifier in cooking, laundry, bathing and dish-washing areas that have excessive moisture.
6. Place the dehumidifier away from clothes dryer.
7. Use the dehumidifier in a basement to help prevent moisture damage.
8. The dehumidifier must be operated in an enclosed area to be most effective. Close all doors, windows and other outside openings to the room.

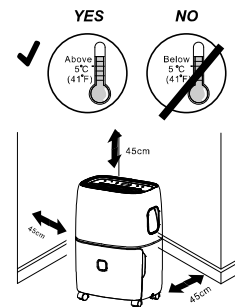

CLEAN AND MAINTENANCE

Before cleaning or maintenance, turn the appliance off by pressing the "POWER" button on the control panel and then unplug it from the power socket after the appliance completely stops.

CLEAN THE DEHUMIDIFIER

Clean the appliance with a slightly damp cloth then dry with a dry cloth.

- Never splash water on the appliance. It may cause electric shock or damage to the appliance.
- Never use petrol, alcohol or solvents to clean the appliance.
- Never spray insecticide or similar chemicals on the appliance.

CLEAN THE FILTER

To keep your appliance working efficiently, you should clean the filter every week of operation.

The filter can be removed like the illustration to the right. Use a vacuum cleaner to remove dust accumulations from the filter. If it is very dirty, immerse in warm water and rinse a number of times. The water should never be hotter than 40°C(104°F). After washing, leave the filter to dry then attach the intake grille to the appliance.

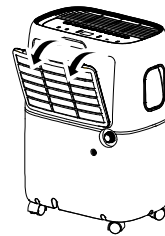

END OF SEASON OPERATIONS

- Unplug it from the power socket, empty the bucket, and remove the drainage cap.
- Run off all water left. When all the water has been drained, put the cap back in place.
- Clean the filter and dry it thoroughly before putting it back.
- Cover the appliance to prevent it from dust.
- Store the appliance upright in a dry location.

START OF SEASON CHECKS

Make sure the power cord and plug are undamaged and plug it to a grounded power socket.

Follow the installation instructions precisely.

TROUBLESHOOTING

Occasionally, you may encounter some problems that are of a minor nature and a service call may not be necessary. Use this troubleshooting guide to identify possible problems you may be experiencing

Problem	Possible Causes	Solutions
Dehumidifier does not start	The dehumidifier is unplugged.	Make sure the dehumidifier's plug is pushed completely into the outlet.
	The fuse is blown or circuit breaker is tripped.	Check the house fuse/circuit breaker box and replace fuse or reset breaker.
	Dehumidifier has reached its setting humidity or the bucket is full.	The dehumidifier automatically turns off when either condition occurs. Change to a lower setting or empty the water bucket.
	Bucket is not in the proper position.	The bucket must be placed properly for the dehumidifier to operate.
	Power Failure	There is a protective time delay (up to 3 min.) to prevent compressor overload. For this reason, the unit may not start normal function for 3 min after it is powered back on.
Dehumidifier does not dry the air as it should	Not enough time allowed for The unit to remove moisture.	For first use, allow at least 24 hours for the unit to reach the setting humidity.
	Airflow is restricted	Make sure there are no curtains, blinds, or furniture blocking the front or back of the dehumidifier. See the LOCATION REQUIREMENTS section.
	Dirty filter	See the CLEAN FILTER section.

TROUBLE SHOOTING

Problem	Possible Causes	Solutions
Dehumidifier does not dry the air as it should	The Humidity Control may not be set low enough	For drier air, press the ✓ button to lower the humidity setting or set the dehumidifier to [] for continuous mode.
	Doors and windows may not be closed tightly	Check that all doors, windows, and other openings are securely closed.
	Clothes dryer may be blowing moist air into the room	Place the dehumidifier away from the dryer. The dryer should be vented outside.
	Room temperature is too low	The dehumidifier performs better at higher room temperature. Lower room temperature will reduce the moisture removal rate. This model is designed to operate at temperature above 5°C(41°F).
Appliance runs too long	The area is too large	Use a dehumidifier with higher capacity.
	Doors and windows are open	Close the door and window.
Frost appears on evaporative coils	Appliance runs recently or the room temperature is too low	It is normal. Frost usually disappears in 60 mins.
Fan noise	The air is passing through the appliance	This is normal.
Water on the floor	The drain connection may be deteriorating or loose	Check the drain connection and the appliance is placed on level surface.
	The drain pipe is connected, but the water is not drained	If use the bucket, remove the drain pipe and put back the drain cover; or install the drain pipe correctly.

ERROR CODES

If the following error code appears, please check the causes and solution.

CODE	DESCRIPTION	POSSIBLE CAUSES	SOLUTIONS
EH	Humidity sensor failure	Humidity sensor is damaged.	Contact customer service center.
E1	Temperature sensor failure	Temperature sensor is damaged.	Connect customer service center.
E2			
E3	Refrigerant leakage or high ambient temperature	Ambient temperature is too high.	Move the appliance to cooler place.
		E3 appears many times. (Note 2)	Contact customer service center.
P1 (Note 1)	Bucket pulled out	The bucket isn't in proper position.	Re-install the bucket properly.
E5 (Note 1)	Pump failure	Didn't install the pump drainage kit before starting pump function.	Install the pump drainage kit before starting pump function.
		Users use non-standard drainage pipes. (Manufacturer's original pipe)	Use the original pipe.
		The drain connector is not tightened.	Tighten the connector.
		The rubber gasket is missing.	Re-install the gasket.
		Poor connection between drain pipe and drain connector.	Check the connection of pipe and drain connector.

Note:

1. The code "P1" and "E5" are only for built-in pump model SD-54PE, other models have not these two codes.

2. If E3 appears, please check the ambient temperature.

If the ambient temperature is over 90°F, place the unit in the place below 90°F.

(below 86°F is suggested) for two hours before running the dehumidifier again.

Turn on the unit. If the E3 appears again in 2 hours, please contact the service center.

Working environment: 41°F~90°F (5°C~32°C), 30%RH~90%RH



Your Guarantee

If this product is found to be faulty as a result of faulty materials or workmanship within one year from date of purchase, it will be repaired free of charge.

This guarantee is subject to the following terms:

- Sunpentown must be notified of the fault.
- Proof of purchase must be presented to Sunpentown's nominated representative.
- The warranty will be void if the product is modified, misused or repaired by an unauthorized person.
- The warranty after repair will not be extended beyond the original one-year period.
- All replacement parts will be new or reconditioned.
- Parts, which are replaced, become the property of Sunpentown.
- The warranty applies for the use of the product in the USA only.

What is NOT COVERED:

- Warranty does not include freight charges.
- Damage due to installation error, product abuse and/or misuse.
- Incidental or consequential damage caused by possible defects with this product.
- Labor cost incurred for the installation and/or removal of a possible defective unit.
- Damage to product caused by improper power supply voltage, accident, fire, floods or acts of nature.
- Failure of product resulting from unauthorized modifications to the product.
- Improper installation or failure to perform the necessary maintenance.
- Normal wear and tear on parts or replacement of parts designed to be replaced.
- Damage to personal property from use of product.
- Replacement or repair of household fuses, circuit breakers, wiring or plumbing.

This GUARANTEE is in addition to your Statutory Rights

SUNPENTOWN INTERNATIONAL INC.
14625 Clark Ave. City of Industry, CA 91745
Tel: 800-330-0388
service@sunpentown.com
www.sunpentown.com